

Buff coloured granite paving setts on the vehicular access contrasts with Caithness flagstone

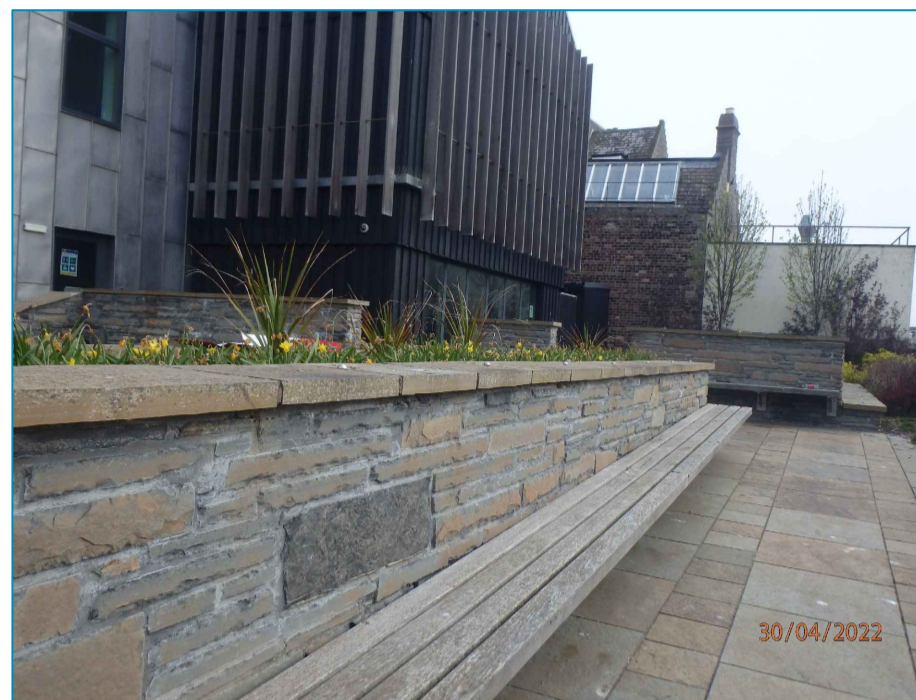

Caithness flagstone planters with built in bench seating.

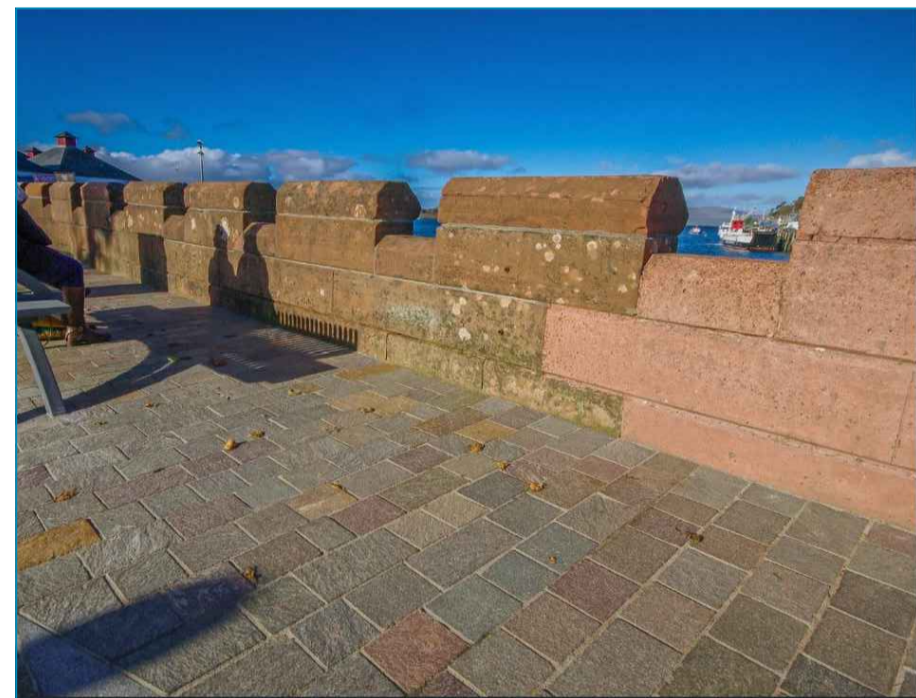

'Pocket Park' area gives views over the riverside and includes seating, paved areas and planters. The paving design combines multi-toned porphyry paving (above) and a feature paving area of Caithness flagstone laid on edge to give a 'wave pattern'. This paving could be interspersed with shoals of fish set into the paving as an element of artwork.

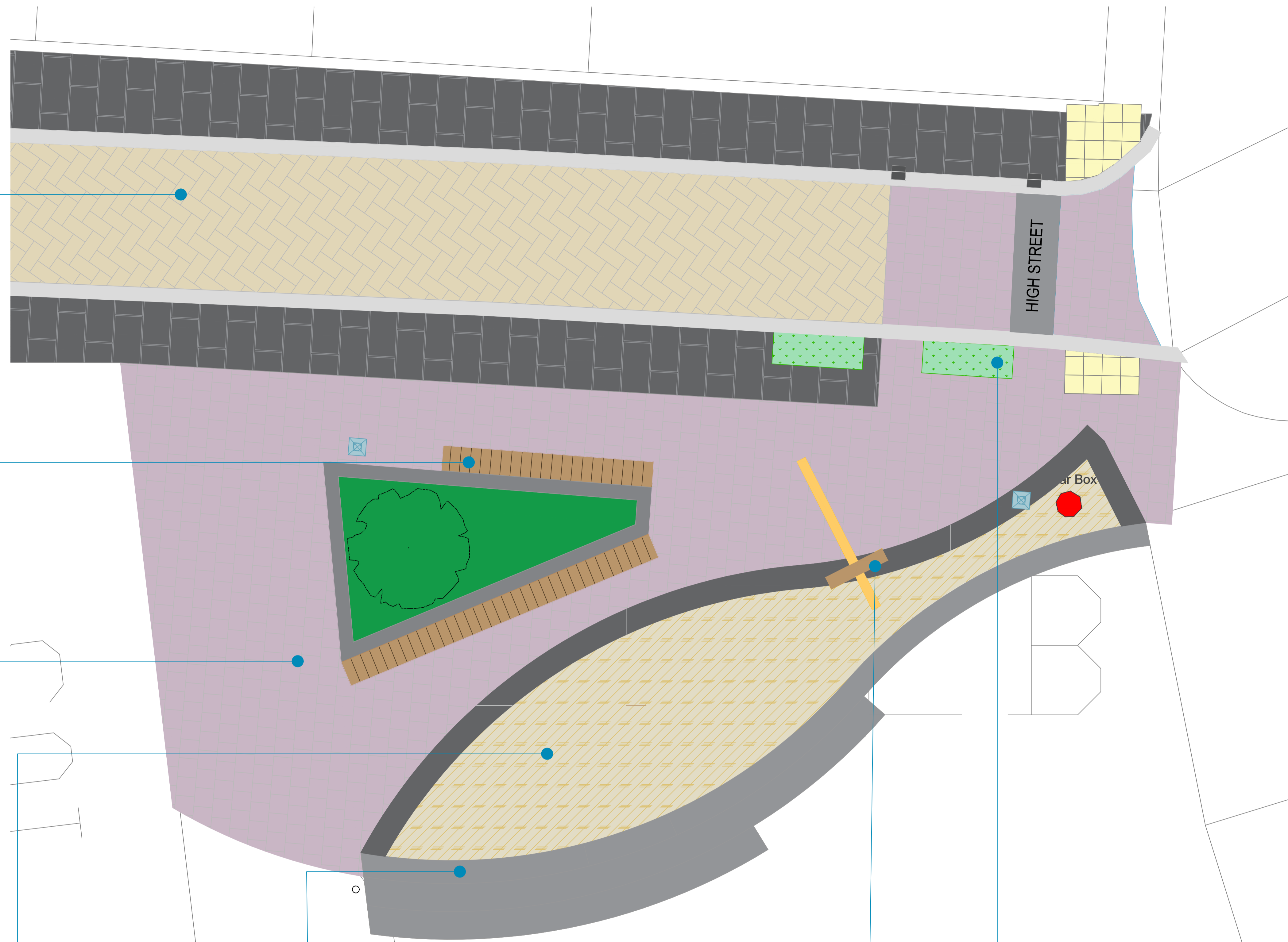

Low walls enclose the paved area and could include a series of steps down the embankment which forms a small amphitheatre

The entrance to the High Street could incorporate an element of public art combined with interpretation which reflects the story of the herring industry.

Planters can be inscribed with text and act to form a gateway feature to the pedestrian area.

