

**Location**

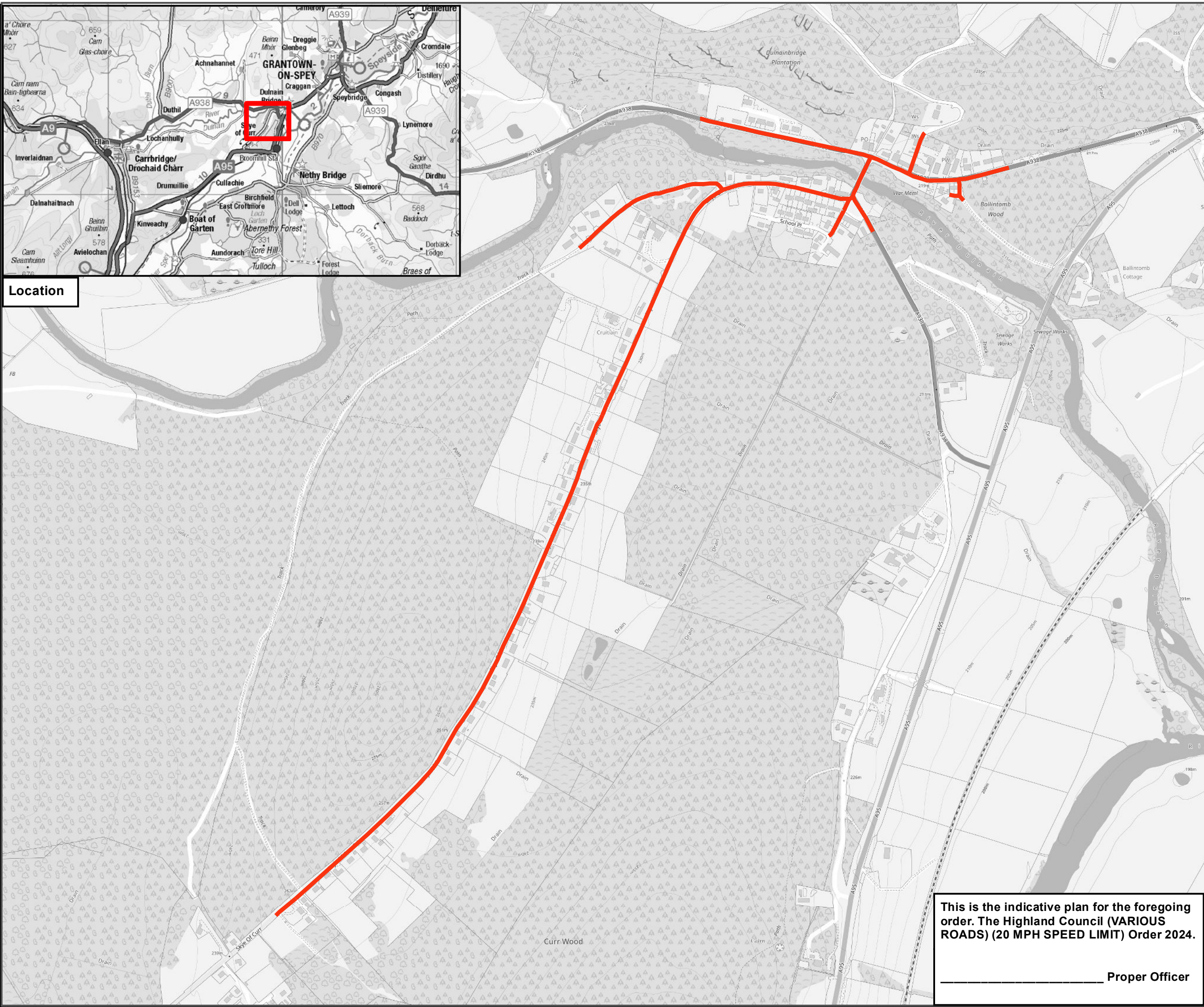

**COPYRIGHT, DESIGNS and PATENTS ACT 1988:**

This drawing may not be reproduced, copied or used in any way without the written permission of the Executive Chief Officer of Infrastructure, Environment and Economy.

© The Highland Council 2024

**NOTES:**

Reproduced from the Ordnance Survey mapping with the permission of the Controller of His Majesty's Stationery Office © Crown copyright. Unauthorised reproduction infringes Crown copyright and may lead to prosecution or civil proceedings. The Highland Council 2024 AC0000849432

**20 mph Speed Limit**



--	--	--	--	--

Revision Details	Drawn By	Check By	Date	Suffix
------------------	----------	----------	------	--------



**INFRASTRUCTURE AND ENVIRONMENT**

Roads & Infrastructure Headquarters  
 Glenurquhart Road  
 Inverness  
 IV3 5NX

Project:  
**20 mph Early Adoption**

Title:  
**TRO Extents**

Scale ( At A3): **1 : 7,000**

Drawn: RB Date: 24/10/2024

Checked: Date:

Project No:

Drawing No: TROE\_077 Rev:

**This is the indicative plan for the foregoing order. The Highland Council (VARIOUS ROADS) (20 MPH SPEED LIMIT) Order 2024.**

\_\_\_\_\_  
 Proper Officer