

Agenda Item	3
Report No	HC/35/14

**BURIAL GROUND EXTENSION**

**Report by Head of Corporate Governance**

**Summary**

This report invites the Council to agree to provide for the extension of the existing burial grounds at Nairn, Fodderty, Tain, Portree, Acharacle and Kilvean.

**1 BACKGROUND**

- 1.1** In order to determine whether an extension to any existing burial ground should be provided, the Council is obliged to follow a requisition and special meeting procedure set out in Section 9 of the Burial Grounds (Scotland) Act 1855. This Report only concerns the process which must be followed under Section 9 of the 1855 Act. The acquisition of land, where required, is dealt with separately.
- 1.2** In accordance with Section 9 of the 1855 Act, a requisition has been received, signed by two Members requiring that a special meeting be held to determine whether the following extensions to existing burial grounds should be provided:
- (a) an extension to the burial ground at Nairn should be provided using land at Granny Barbour Road, Nairn, as per the attached **Plan 1**.
  - (b) an extension to the burial ground at Fodderty, as per the attached **Plan 2**.
  - (c) an extension to the burial ground at St Duthus Cemetery in Tain as per the attached **Plan 3**.
  - (d) an extension to the burial ground at Portree as per the attached **Plan 4**.
  - (e) an extension to the burial ground at Acharacle as per the attached **Plan 5**.
  - (f) an extension to the burial ground at Kilvean, as per the attached **Plan 6**.
- 1.3** An extension will be provided in accordance with the 1855 Act if the majority of those Members voting at a special meeting resolve that the proposed extensions to the existing burial grounds are to be provided.

- 1.4 The budget for burial ground extensions by Community Services is accommodated in the Council's Capital Programme, as approved at Highland Council on 27 June 2013.

## 2 PROPOSALS

At the Transport, Environmental and Community Services Committee on 14 March 2013, Report No. TEC/26/13 was circulated which highlighted that a number of cemeteries were reaching full capacity and it recommended that a 10 year cemetery extension/replacement programme was developed – this was approved. At the Transport, Environmental and Community Services Committee on the 6 February 2014, Report No. TEC/8-14 was circulated which provided members with an update on the cemetery extension/replacement programme and noted that the burial grounds at Acharacle, Fodderty, Nairn, Portree and Tain all had less than 5 years capacity whilst the burial ground at Kilvean had 10 years capacity left.

## 3 IMPLICATIONS

There are no legal, equalities, climate change/carbon clever, risk, Gaelic or rural implications arising as a direct result of this report.

### **RECOMMENDATION**

The Council is asked to agree to provide the burial ground extensions as listed above at Paragraph 1.2 under Section 9 of the Burial Grounds (Scotland) Act 1855, as amended.

Signature:

Designation: Head of Corporate Governance

Date:

Background paper: Signed requisition dated 16 October 2014

# DRAFT

**NOTES**  
 This drawing is for information only and is not to be used for construction. It is the responsibility of the client to ensure that all necessary permissions and consents are obtained before any work is carried out. The Highland Council reserves the right to amend this drawing without notice.

Revision	Details	Date	By

**The Highland Council**  
**Comhairle na Gàidhealtachd**  
**TRANSPORT, ENVIRONMENTAL & COMMUNITY SERVICES**  
 PROJECT DESIGN UNIT  
 COMMUNITY DEVELOPMENT  
 BRIDGE STREET, INVERALL  
 NISS - SIBRE, IV12 9JF  
 Phone : 01849 888000  
 Fax : 01849 888001

<b>PROJECT</b>	
<b>NAIRN CEMETERY EXTENSION</b>	
<b>LAND INTEREST PLAN</b>	
Code (or A3)	As Shown
Drawn	EG
Checked	JM
Date	MAR 2013
Date	MAY 2013
Project No.	HJG1002
Sheet No.	HJG1002 LP 1
Rev.	

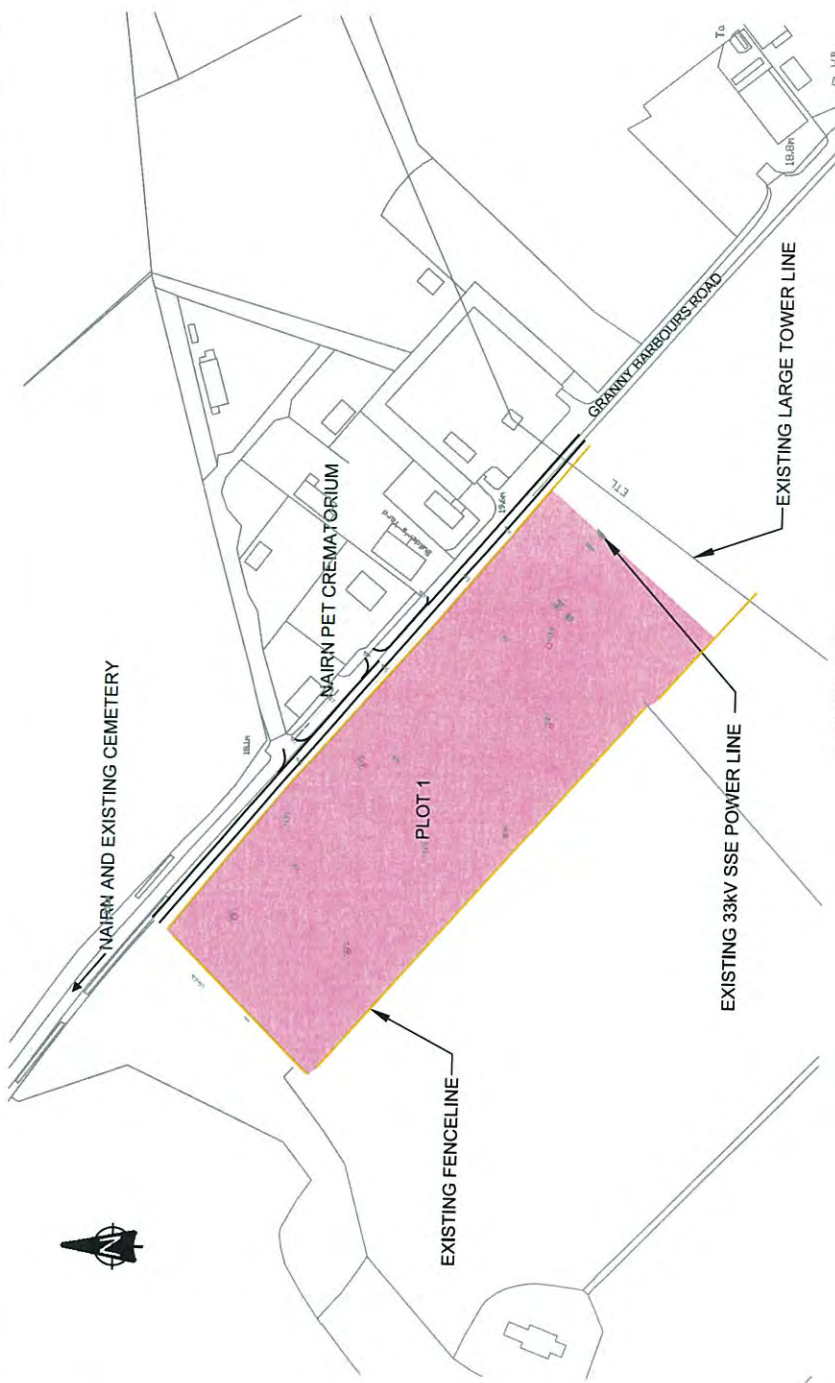

SCALE 1:2500



LOCATION MAP NOT TO SCALE

Plot No	Owner	Occupier	Area (sq.m)	Agreement Required	Notes
1	Mr and Mrs Nicolson, Househill Mains, Grantown Road, Nairn, IV12 9RY	Mr and Mrs Nicolson, Househill Mains, Grantown Road, Nairn, IV12 9RY	30000	Acquisition Area	Secure land for future cemetery extensions.



**COPYRIGHT, DESIGN AND PATENT ACT 1988**  
 This drawing shall be reproduced, stored or used in any form or by any means, electronic or mechanical, including photocopying, recording, or by any information storage and retrieval system, without the prior written permission of the Highland Council, 1987.

**NOTES**  
 Reproduced from the Ordnance Survey map, sheet 631 500,000, 1:50,000, 1987. The map is the property of the Ordnance Survey, which is a Crown Copyright. The Ordnance Survey is a Government Department. The Ordnance Survey is a Government Department. The Ordnance Survey is a Government Department.

Revision Details



**The Highland Council**  
**Comhairle na Gàidhealtachd**

TRANSPORT, ENVIRONMENTAL & COMMUNITY SERVICES

AH  
 HIGH STREET, DINGWALL  
 ROSS-COIRE, IV16 6QN  
 Phone : 01849 866440  
 Fax : 01849 862100  
 E-Mail : ah@ah@highland.gov.uk

Foderty Burial Ground	
Scale	1:1250
Date	10/09/2014
Author	
Checked	
Approved	
Project No.	

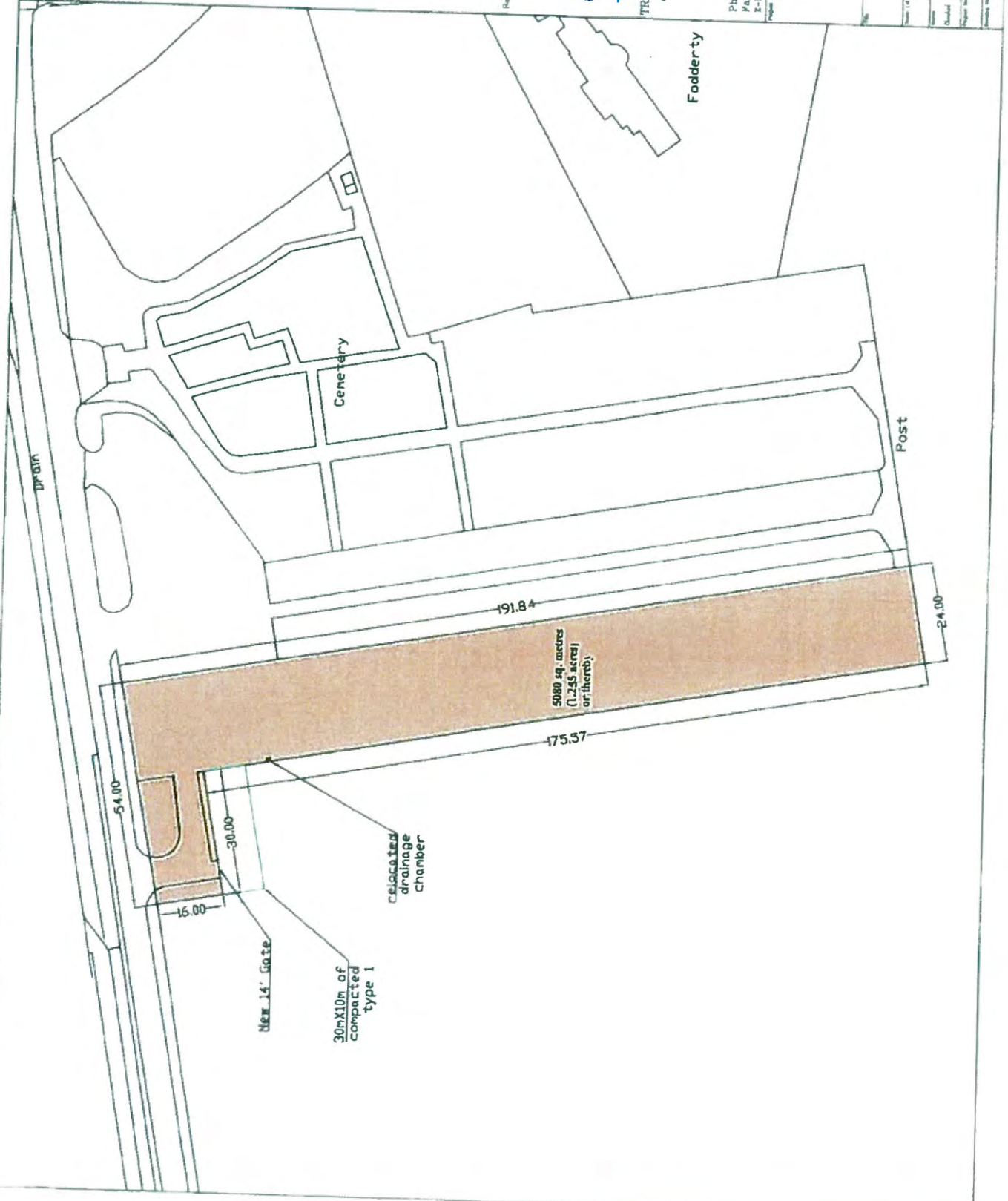

Land Take



# DRAFT

**COMMITTEE MEMBERS AND MEMBERS OF THE PUBLIC**  
 The design and construction of this plan is the responsibility of the Highland Council.  
 © THE HIGHLAND COUNCIL

**Notes**  
 Reproduced from the Ordnance Survey map, with permission of the Ordnance Survey. All rights reserved. Ordnance Survey Licence No. 100025218.  
 The Highland Council is not responsible for any errors or omissions in this plan.

Revision Details	Drawn By	Checked By	Date	Scale

**The Highland Council**  
 Comhairle na Gàidhealtachd

**DEVELOPMENT & INFRASTRUCTURE**  
 PROJECT DESIGN UNIT  
 Council Buildings  
 High Street  
 Inverness  
 Original

Phone: 01349 868800  
 Fax: 01349 864031  
 Email: [development@highland.gov.uk](mailto:development@highland.gov.uk)

Project Name	St Duthus Cemetery Extension Tain
Site No.	Cemetery Plan
Scale	As Shown
Drawn	DM
Checked	DMFT
Project No.	HNG1005
Drawn No.	08



**LOCATION PLAN**  
 SCALE 1:25,000

**KEY:**  
 AREA FOR BURIALS

**BOUNDARY CO-ORDINATES:**  
 A: 278394.2E, 882248.1N  
 B: 278431.3E, 882225.0N  
 C: 278379.8E, 882143.2N  
 D: 278342.3E, 882165.8N

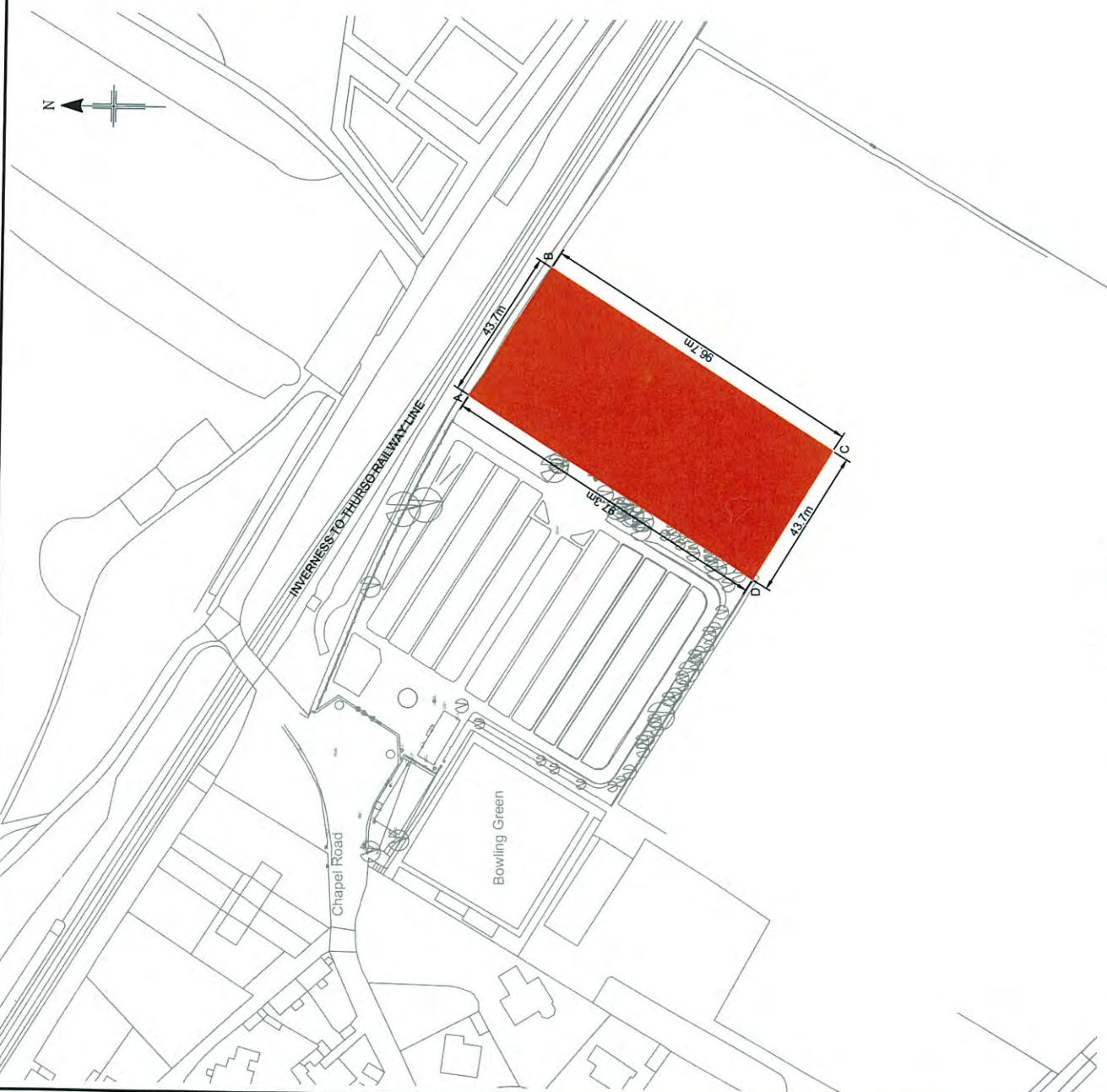

**SITE LAYOUT**  
 SCALE 1:1250











**CONTRACT DESIGN AND PERMIT ACT 1988**  
 The Architect is a member of the Institute of Professional Architects of Ireland (I.P.A.I.)  
 © THE HIGHLAND COUNCIL

**Notes**  
 Prepared from the Ordnance Survey map, with  
 necessary amendments to show the proposed  
 extension of the cemetery. The site is shown in  
 red on the map. The site is shown in red on the map.  
 The site is shown in red on the map.

Drawn	Checked	Author	Date

**The Highland Council**  
**Comhairle na Gàidhealtachd**

**DEVELOPMENT & INFRASTRUCTURE**  
 PROJECT DESIGN UNIT  
 O'Connell House  
 Alness Road Business Park  
 Alness IV17 0UP

Phone: 01549 880741  
 Fax: 01549 887849  
 Email: [planning@highland.gov.uk](mailto:planning@highland.gov.uk)

<b>Kilvean Cemetery Extension</b>	
<b>Cemetery Plan</b>	
<b>As Shown</b>	
Drawn	JAS
Checked	JAS
Date	03/09/2014
Project No.	HVG1007
Drawing No.	CP/01

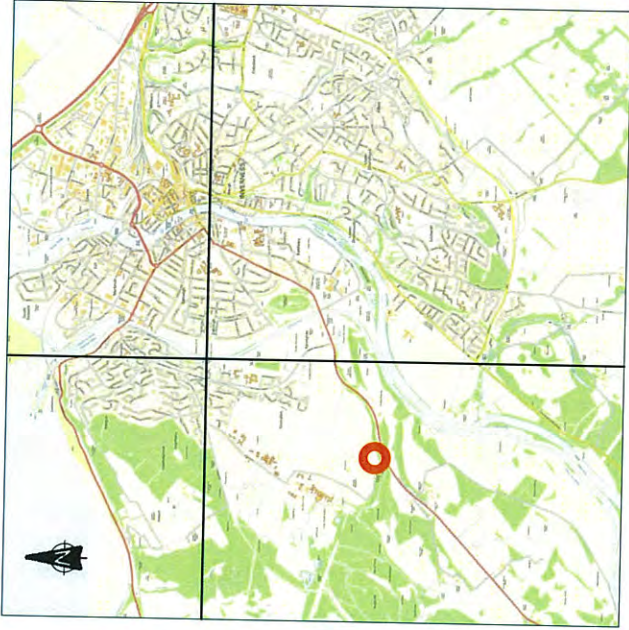

Location Plan  
 Scale 1:50,000

- Key**
- Burial Area (11,688.46m<sup>2</sup>)
- Boundary Co-ordinates:**
- A - 263981, 843316
  - B - 264130, 843270
  - C - 264127, 843258
  - D - 263954, 843212



Site Layout  
 Scale 1:2500