

**The Highland Council**  
**City Of Inverness Area Committee**  
**2 December 2014**

Agenda Item	9(a)
Report No	CIA/61 /14

**Proposed Addition to List of Roads**

**Report by Director of Community Services**

**Summary**

This report invites Members to recommend to the Community Services Committee adoption of the carriageway spur road that extends from Old Edinburgh Road to Temple Crescent.

**1. Introduction**

1.1 Under the Council's Scheme of Delegation the City of Inverness Area Committee can "make recommendations on the deletion and adoption of roads to the Community Services Committee". The carriageway spur road extends from Old Edinburgh Road to Temple Crescent along the frontages of numbers 152 to 160 Old Edinburgh Road and number 59 Temple Crescent.

**2. Legislation**

2.1 Section 1(1) of the Roads (Scotland) Act 1984 places a duty on the Roads Authority to maintain all roads entered in their List of Roads.

2.2 Section 1(4) of the Roads (Scotland) Act 1984 states that the Local Roads Authority may add or delete from their List of Roads.

**3. Background**

3.1 The houses fronting this spur road belong to Cairn Housing Association whose tenants complained to the Ward Manager and the Local Member about its poor state of repair.

3.2 Cairn Housing Association paid TEC Services to bring this spur road up to Adoptive Standard and requested that it be adopted on to the public List of Roads

3.3 The carriageway spur including the parallel parking bay is now in good order is 60metres or thereby long by 3metres or thereby wide. The parallel parking bay is 2.4metres or thereby wide by 23metres or thereby long with 7metre or thereby long tapers at each end. Both the carriageway and parking bay are surfaced in bitumen macadam

#### 4. **Proposal**

- 4.1 The proposal is to adopt the spur section of carriageway including the parallel parking bay that extends from Old Edinburgh Road to Temple Crescent along the frontages of numbers 152 to 160 Old Edinburgh Road and number 59 Temple Crescent that is not included in the current adopted List of Roads.
- 4.2 The description of Old Edinburgh Road in the List of Roads will be updated to incorporate the adoption of this spur road.

#### 5. **Implications**

- 5.1 **Resource implications** – Maintenance responsibility for the road lies with the Council. Any maintenance of the road will be covered by the Annual Roads Maintenance Budget.
- 5.2 **Legal implications** – There are no legal implications as the Council is required to maintain the road as indicated on the plan in **Appendix A**.
- 5.3 There are no known specific equality, climate change/carbon clever; risk or Gaelic implications arising from this proposal.

#### **Recommendation**

Members are invited to recommend to the Community Services Committee, the adoption of the carriageway spur road fronting numbers 152 to 160 Old Edinburgh Road and 59 Temple Crescent as outlined in **Appendix B**

Designation: Director of Community Services

Date: 14th November 2014

Author: Richard Brown, Technician,

# Appendix A

## Drawing showing Road to be adopted

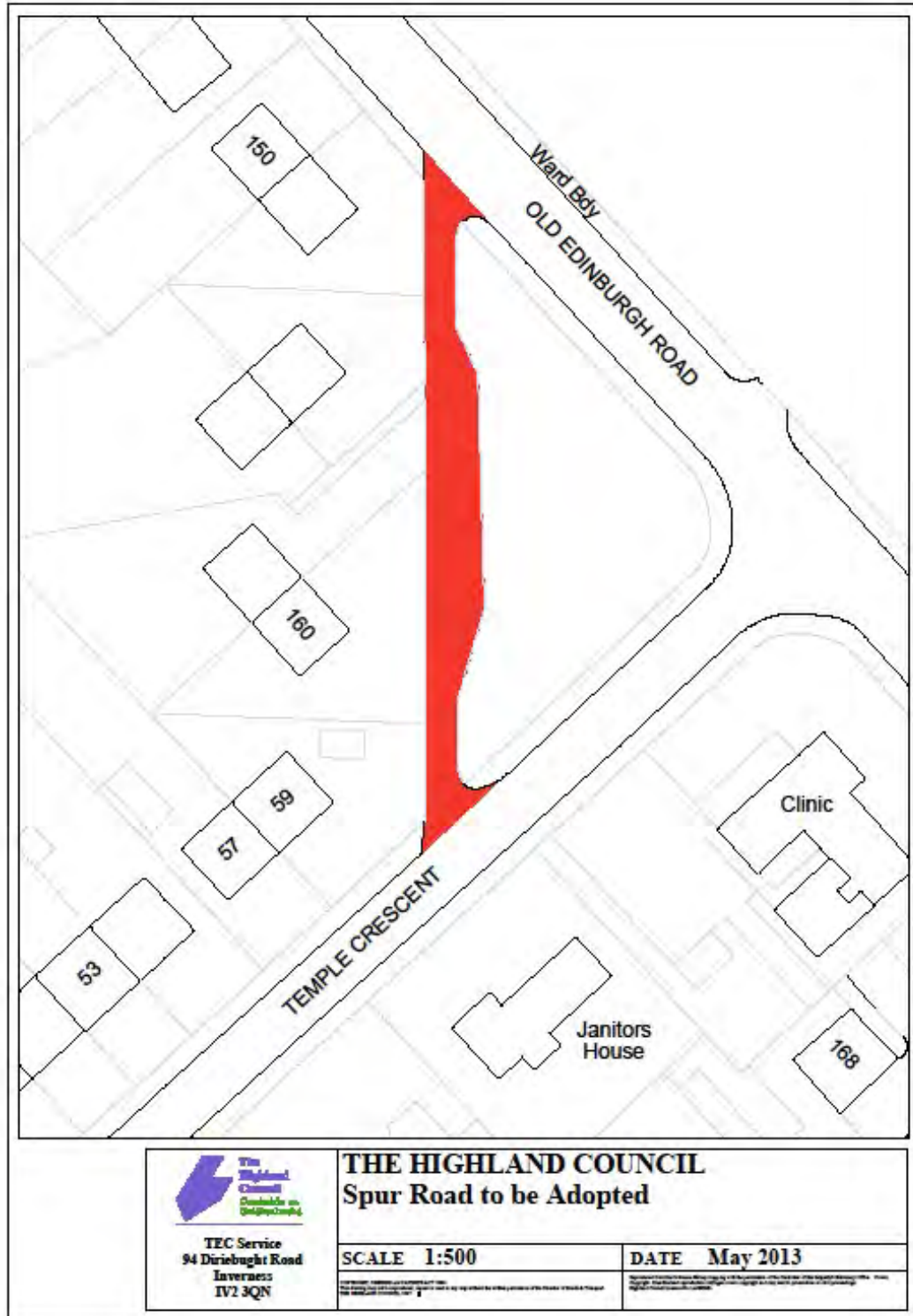

## Appendix B

### Carriageway Spur Between Old Edinburgh Road and Temple Crescent to be adopted

<b>Road Number</b>			Date of Adoption	
<b>Description</b>	CARRIAGEWAY SPUR OFF OLD EDINBURGH ROAD			
<b>Length of Adopted Road</b>	Miles	0.012	KM	0.060
<b>OS Coordinates</b>	Start	267528 843857	End	267528 843793
<b>Adopted Road Description</b>	<p>Commencing at its junction with Old Edinburgh Road at a point 45metres or thereby northwest of the north western kerb line of Temple Crescent extending in a southerly direction a distance of 60metres or thereby to its junction with Temple Crescent, a road 3.0metres or thereby wide including a 2.4metre or thereby wide parallel parking bay 23metres or thereby long tapered at both ends.</p> <p>The adopted road extends to boundary fences or walls or in open ground to a distance of 3 metres from the edge of the surfaced carriageway or passing place or to the top of the slope in cutting or to the bottom of the slope in embankment which ever distance is greater.</p>			