

M:\SAC Environmental_Des\Active Contracs\Highland Council\Inverness West Link Road\Project Documents\CAD\2015081_Highland_Planning\Issue_090415.dwg: (Plotted 10 April 2015 by Mary Sheehan)

COPYRIGHT, DESIGNS and PATENTS ACT 1988:
 This drawing may not be reproduced, copied or used in any way without the written permission of the Director of Development & Infrastructure.
 © THE HIGHLAND COUNCIL

Notes

Reproduced from the Ordnance Survey mapping with the permission of the Controller of Her Majesty's Stationary Office © Crown Copyright. Unauthorised reproduction infringes Crown copyright and may lead to prosecution or civil proceedings.
 The Highland Council 2014 100023369

1. 1 no. 100 x 70m 3G IRB Rugby Pitch plus 10m touch-in-goal zone & 5m run-off to all sides
 2. 1 no. 86 x 60m natural grass Rugby Pitch plus 7m touch-in-goal zone & 4 & 5m run-offs
 3. 1 no. 100 x 70m natural grass Rugby Pitch plus 7m touch-in-goal zone & 5m run-off to all sides
 4. 2 no. socketed, 13m fold-down aluminium rugby posts
 5. Technical Zone 10 x 3m
 6. 5m wide hardstanding
 7. 3m wide hardstanding
 8. Retaining wall max 1m high
 9. 8m balltop fence
 10. 6m balltop fence
 11. 4m balltop fence
 12. 3m balltop fence
 13. 2m balltop fence
 14. 3m wide lockable maintenance access gate
 15. 1.2m wide lockable pedestrian access gate
 16. 8 no. fold-down galvanised steel sports lighting columns
 17. Team/Spectator Shelters
 18. Sports Pavilion
 19. Car Park Area
 20. Bus Parking/Drop-off
 21. 1.2m chainlink fence
 22. 6 no. litter bins
 23. Spectator Rail
 24. Feeder Pillar
- POTENTIAL ADDITIONAL ITEMS -**
25. 4 no. 4 station boot scrapers
 26. 6 no. removable corner flags
 27. X no. Do's & Dorts signs
 28. X no. Other signage
 29. 1 no. 11-A-Side football pitch (100 x 70m)
 30. 2 no. 7-A-Side pitches
 31. 4 no. 4.8 x 1.83 mini soccer goals
 32. 1 no. 5-A-Side pitch

Revision Details			
Drawn By	Check By	Check Date	Surfx
MS	MC	09/04/15	

SAC Consulting
 Environment & Design

Edinburgh
 2 Technopole Centre
 Bush Estate, Pentonick
 Midlothian, EH20 0PJ
 www.sac.co.uk

Tel: (0131) 603 7500



CAPITA

The Capita Building
 Kingmoor Business Park
 CARLISLE
 Cumbria
 CA6 4SJ

Tel: 01228 673000
 Fax: 01228 673111

The Highland Council
 Comhairle na Gàidhealtachd

DEVELOPMENT & INFRASTRUCTURE

PROJECT DESIGN UNIT
 Osprey House
 AInness Point Business Park
 AInness, IV17 0UP

Phone : 01349 886741
 Fax : 01349 886749
 E-Mail : jms.smith@highland.gov.uk

Project

RECONFIGURATION OF CANAL PARKS

Title

DETAILED SYNTHETIC PITCH LAYOUT & EQUIPMENT SETUP

Scale (at A1)		1:250	
Drawn	MS	Date	09/04/2015
Checked	MC	Date	09/04/2015
Project No:	HRS7141		Status:
Drawing No:	HRS7141 - PL30		For discussion
			Rev: -

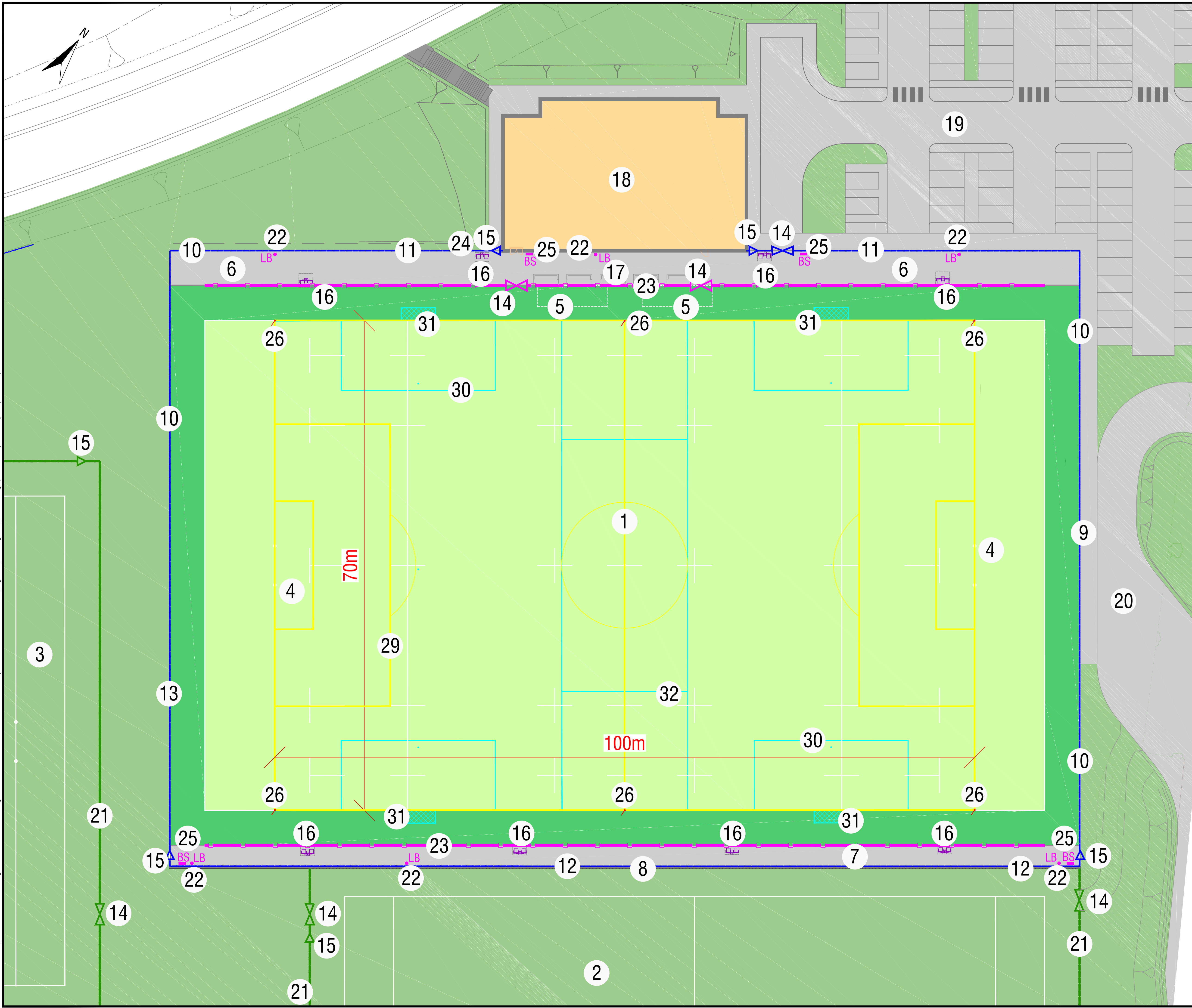

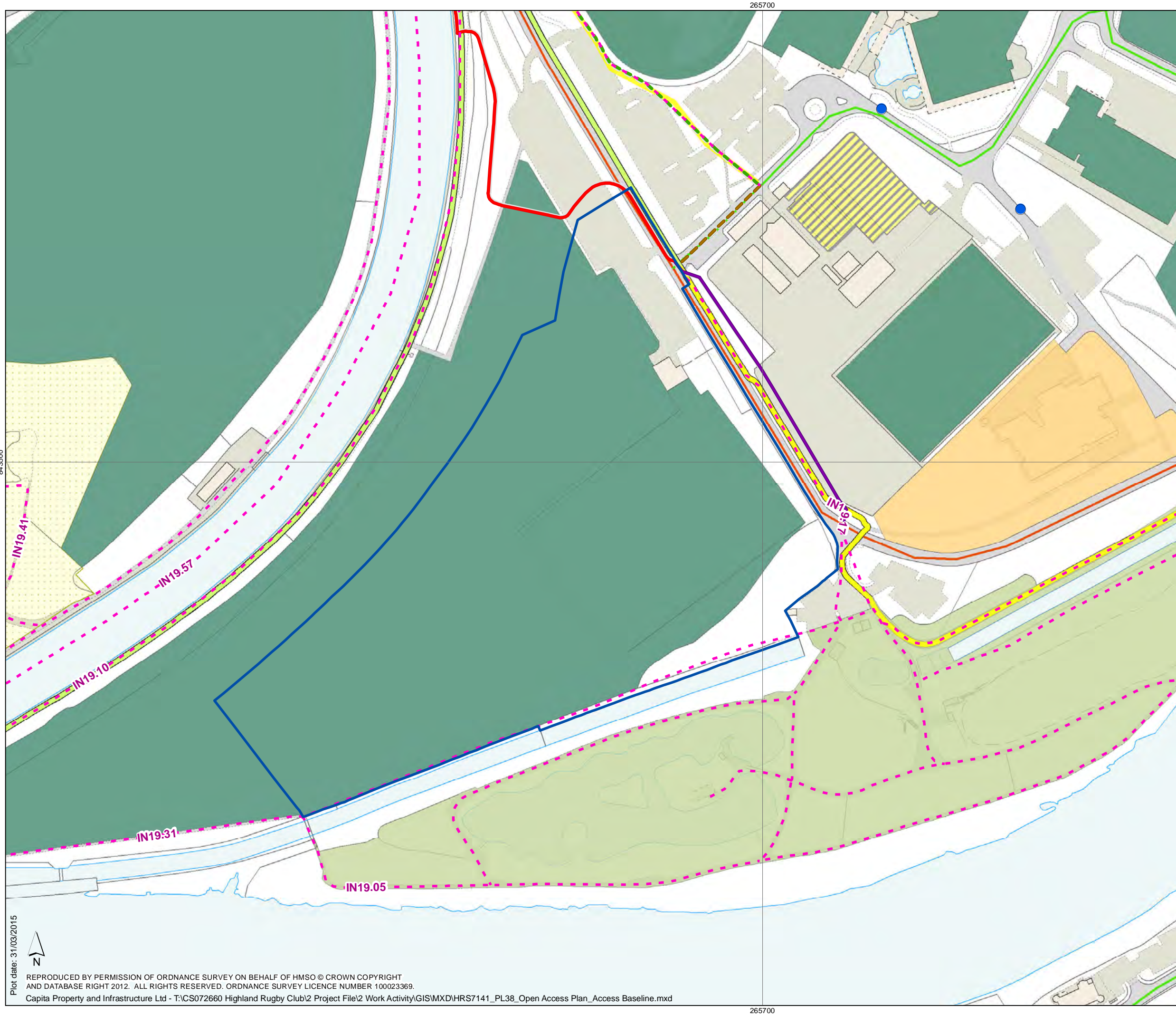

- KEY:**
- Proposed Planning Site Boundary
 - - - Core Path
 - Great Glen Way
 - - - Other Paths (within site boundary)
- Great Glen Way Diversion**
- Proposed Diversion Option A
 - Existing Core Path (GGW status to remove)
 - Existing Core Path (GGW status to remain)
 - Existing Signed Route
- Road Network**
- Road Network (not surveyed)
 - Traffic-free Cycle Route
 - Suitable for Pedestrians (via footway)
 - Not suitable for Pedestrians
 - Existing Bus stops
 - Proposed BusStops
- Land Use**
- Accomodation, BBs
 - Accomodation, Caravan Parks
 - Accomodation, Hotels
 - Leisure, Parks
 - Leisure, Sports
 - Recreation, Boating
 - Retail, Shops
 - Services, Archive / Library
 - Services, Care homes / Hospitals
 - Services, Cemetery
 - Services, School / Pre School
 - Site of Special Scientific Interest



Client
THE HIGHLAND COUNCIL

Project
RECONFIGURATION OF
CANAL PARKS

Drawing
PLANNING APPLICATION
OPEN ACCESS PLAN /
ACCESS BASELINE

Scale @ A3 1:2,000	Drawn SH	Checked JD	Approved JR
Project No CS/072660	Date 31/03/2015		

Drawing Identifier
HRS7141/PL38



Plot date: 31/03/2015



REPRODUCED BY PERMISSION OF ORDNANCE SURVEY ON BEHALF OF HMSO © CROWN COPYRIGHT AND DATABASE RIGHT 2012. ALL RIGHTS RESERVED. ORDNANCE SURVEY LICENCE NUMBER 100023369.
Capita Property and Infrastructure Ltd - T:\CS072660 Highland Rugby Club\2 Project File\2 Work Activity\GIS\MXD\HRS7141_PL38_Open Access Plan_Access Baseline.mxd

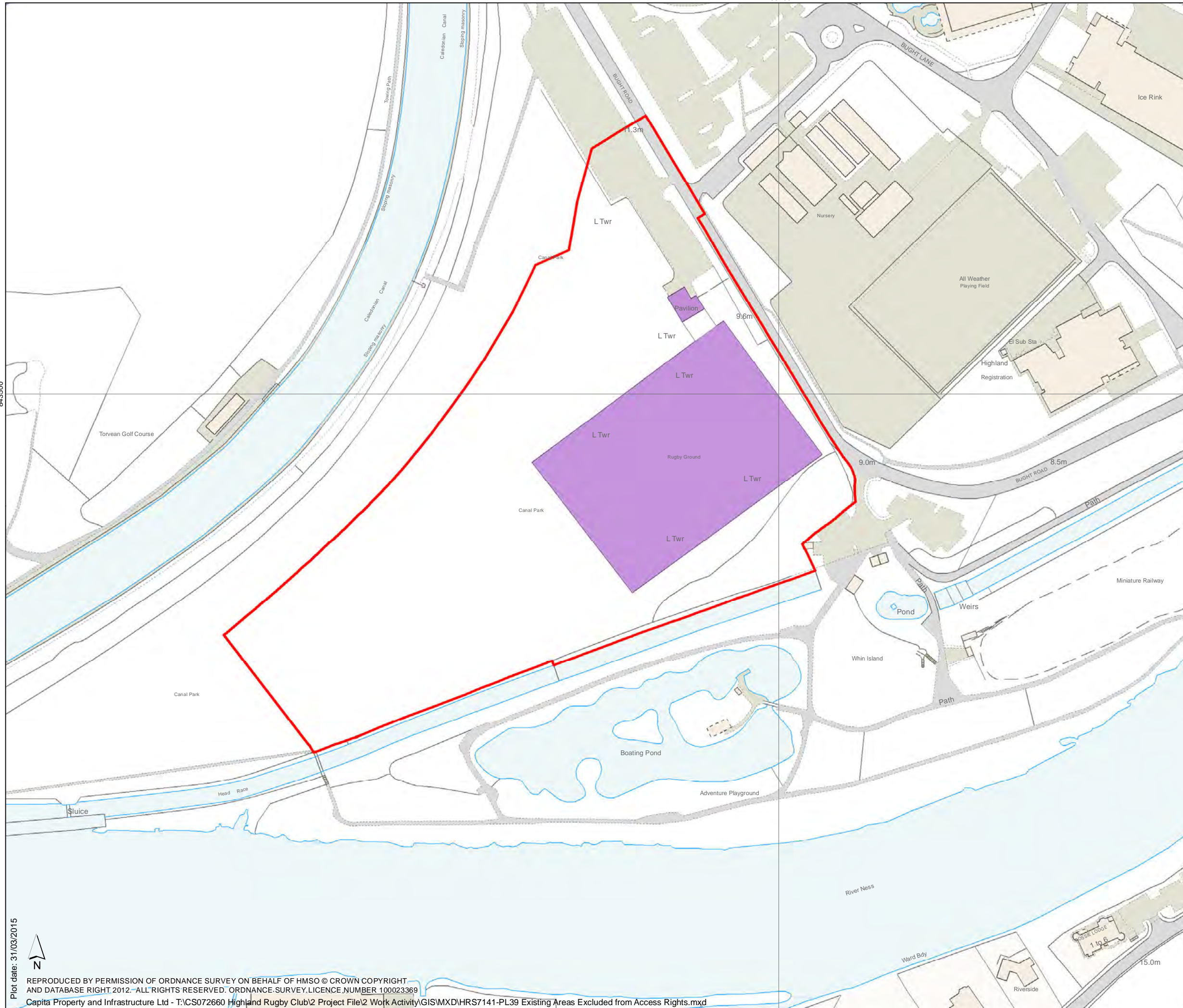

- Key:
- Proposed Planning Site Boundary
 - Land Excluded from Access Rights by Sections 6 and or 7 of the Land Reform (Scotland) Act 2003



Client
THE HIGHLAND COUNCIL

Project
RECONFIGURATION OF CANAL PARKS

Drawing
PLANNING APPLICATION
EXISTING AREAS EXCLUDED FROM ACCESS RIGHTS

Scale @ A3	Drawn	Checked	Approved
1:2,000	SH	JD	JR

Project No	Date
CS/072660	31/03/2015

Drawing Identifier
HRS7141/PL39

CAPITA
Property and Infrastructure

The Capita Building, Kingmoor Business Park, Carlisle, CA6 4SJ
T 01228 673000 www.capita.co.uk/property
Capita Property and Infrastructure Ltd.



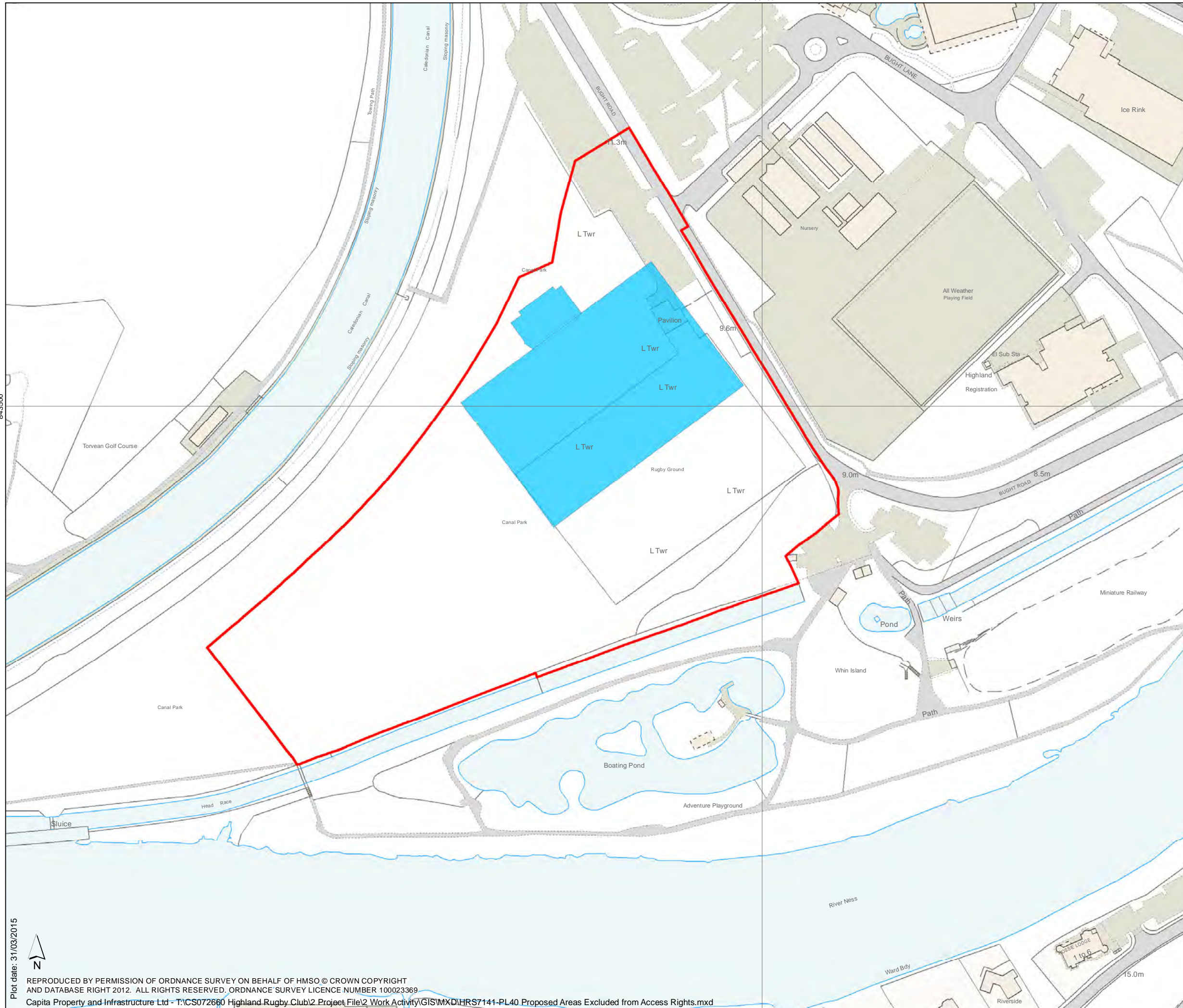

Key:

- Proposed Planning Site Boundary
- Rights by Sections 6 and or 7 of the Land Reform (Scotland) Act 2003



Client
THE HIGHLAND COUNCIL

Project
RECONFIGURATION OF CANAL PARKS

Drawing
**PLANNING APPLICATION
 PROPOSED AREAS EXCLUDED FROM
 ACCESS RIGHTS**

Scale @ A3	Drawn	Checked	Approved
1:2,000	SH	JD	JR

Project No	Date
CS/072660	31/03/2015

Drawing Identifier
HRS7141/PL40

CAPITA
 Property and Infrastructure

The Capita Building, Kingmoor Business Park, Carlisle, CA6 4SJ
 T 01228 673000 www.capita.co.uk/property
 Capita Property and Infrastructure Ltd.

T:\CS072660 Highland Rugby Club\2 Project File\2 Work Activity\GIS\XD\HRS7141-PL41 Site Location Plan - Regional Context.mxd

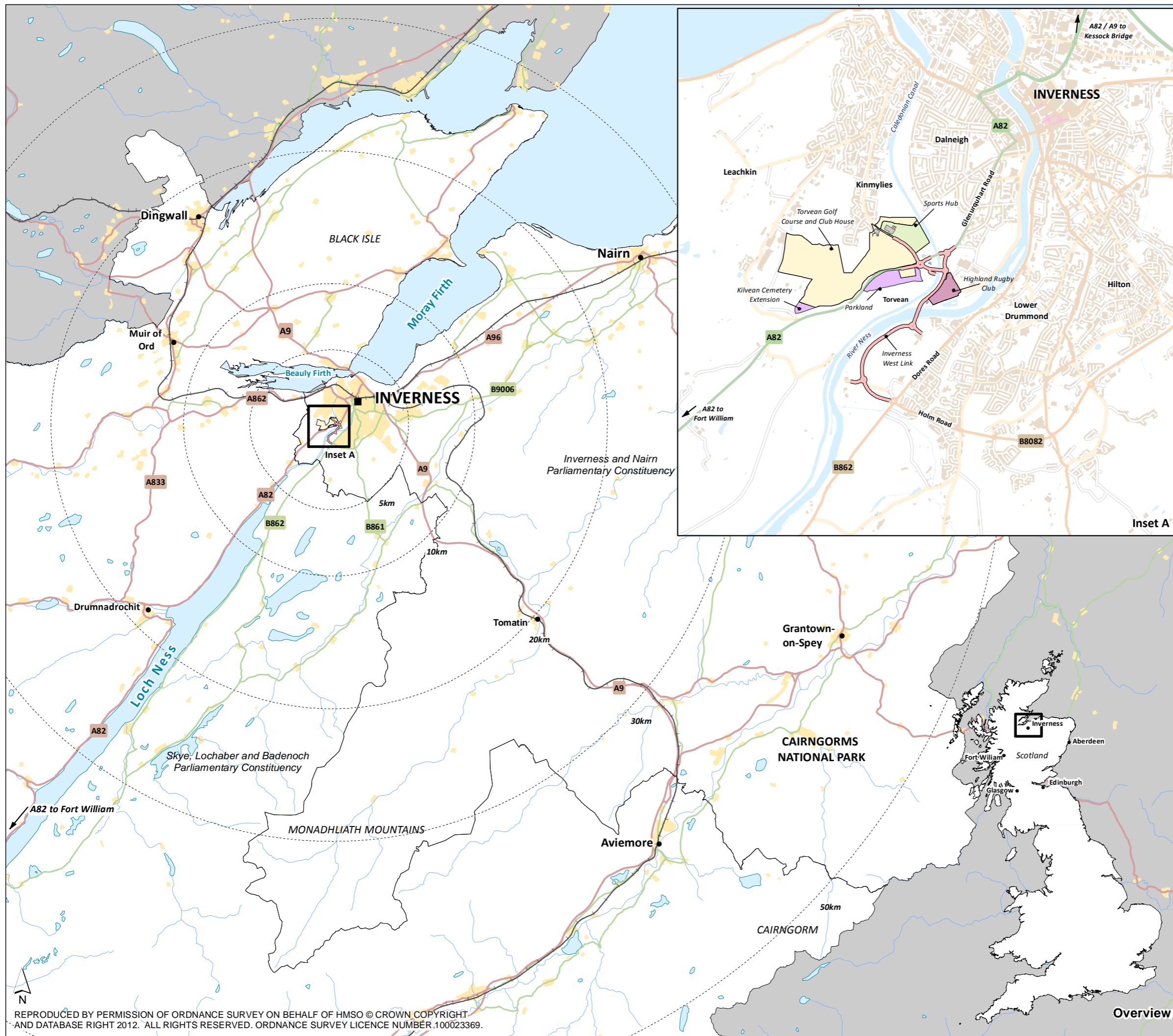

KEY:



Client
THE HIGHLAND COUNCIL

Project
RECONFIGURATION OF CANAL PARKS

Drawing
PLANNING APPLICATION
SITE LOCATION PLAN
REGIONAL CONTEXT

Scale @ A3	Drawn	Checked	Approved
1:40,000	SH	JD	JR

Project No	Date
CS/072660	25/03/2015

Drawing Identifier
HRS7141/PL41

CAPITA
Property and Infrastructure

The Capita Building, Kingmoor Business Park, Carlisle, CA6 4SJ
T 01228 673000 www.capita.co.uk/property
Capita Property and Infrastructure Ltd.

REPRODUCED BY PERMISSION OF ORDNANCE SURVEY ON BEHALF OF HMSO © CROWN COPYRIGHT AND DATABASE RIGHT 2012. ALL RIGHTS RESERVED. ORDNANCE SURVEY LICENCE NUMBER 100023369.

Overview

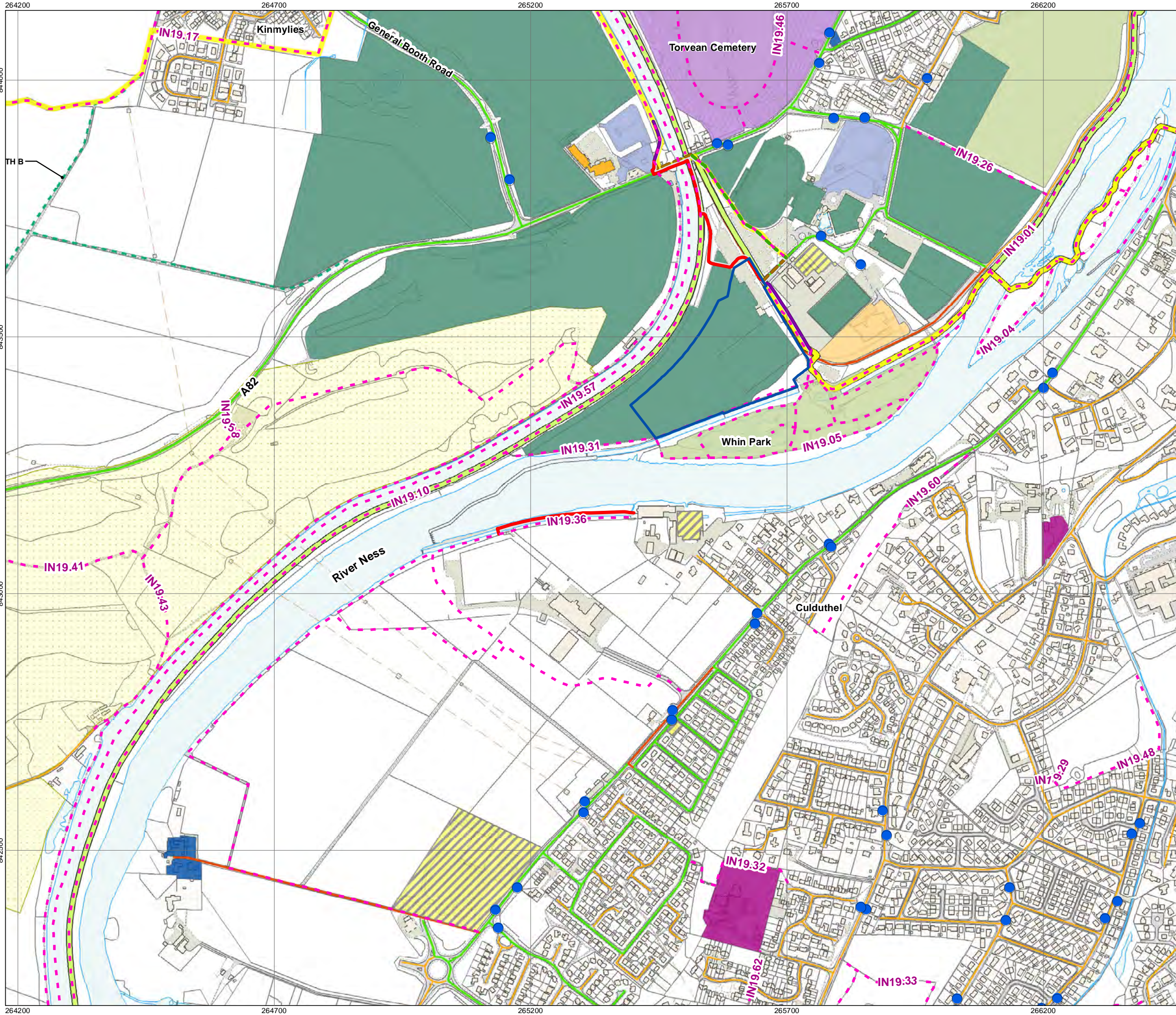

- KEY:**
- Proposed Planning Site Boundary
 - Core Path
 - Great Glen Way
 - Other Paths (within site boundary)
- Great Glen Way Diversion**
- Proposed Diversion Option A
 - Existing Core Path (GGW status to remove)
 - Existing Core Path (GGW status to remain)
 - Existing Signed Route
- Road Network**
- Road Network (not surveyed)
 - Traffic-free Cycle Route
 - Suitable for Pedestrians (via footway)
 - Not suitable for Pedestrians
- Existing Bus stops
- Accommodation, BBs**
- Accommodation, Caravan Parks
 - Accommodation, Hotels
 - Leisure, Parks
 - Leisure, Sports
 - Recreation, Boating
 - Retail, Shops
 - Services, Archive / Library
 - Services, Care homes / Hospitals
 - Services, Cemetery
 - Services, School / Pre School
- Site of Special Scientific Interest



Client
THE HIGHLAND COUNCIL

Project
RECONFIGURATION OF CANAL PARKS

Drawing
**PLANNING APPLICATION
OPEN ACCESS PLAN /
ACCESS BASELINE**

Scale @ A3 1:7,000	Drawn SH	Checked JD	Approved JR
Project No CS/072660	Date 31/03/2015		

Drawing Identifier
HRS7141/PL43

CAPITA
Property and Infrastructure





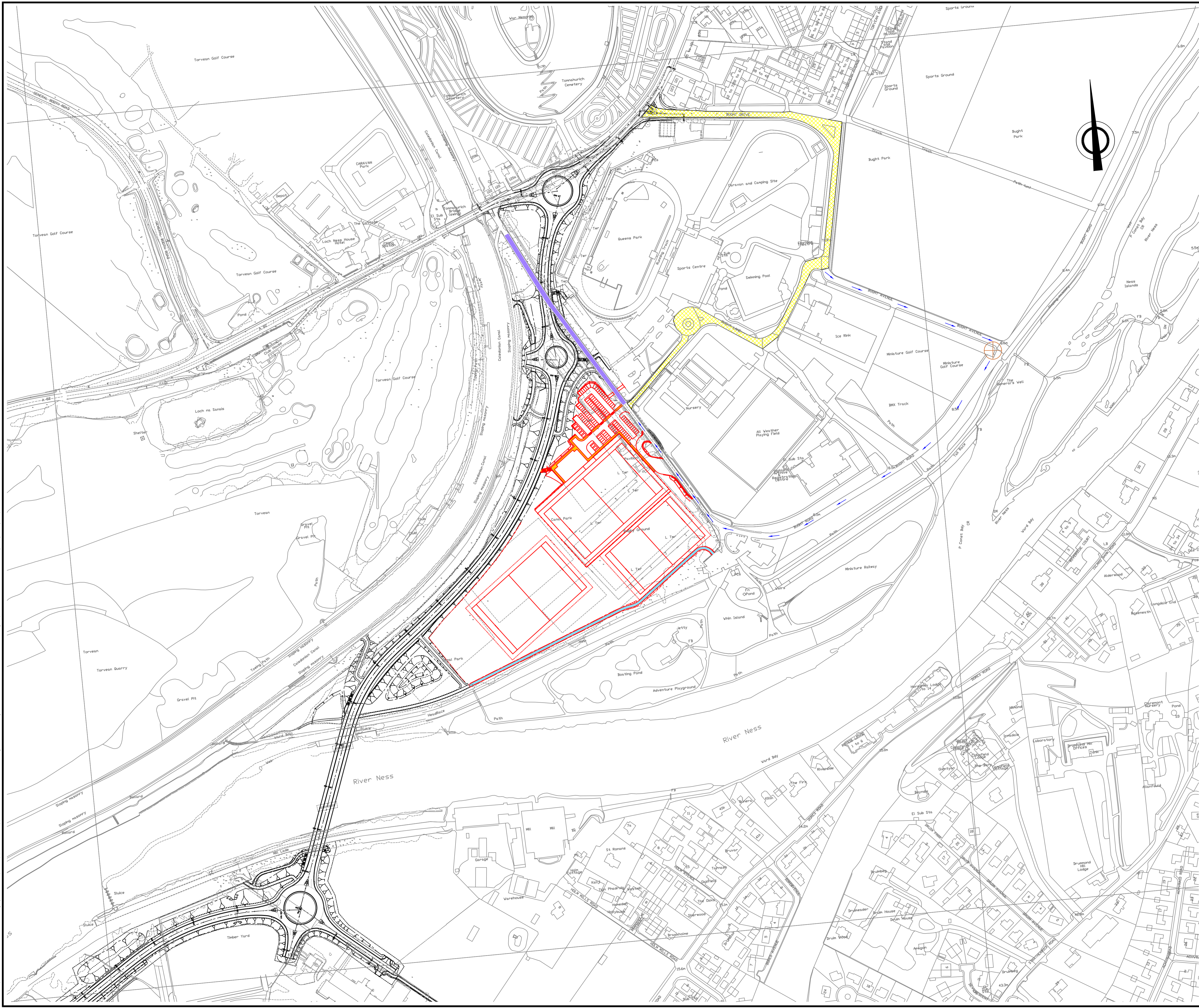

The Capita Building, Kingmoor Business Park, Carlisle, CA6 4SJ
T 01228 673000 www.capita.co.uk/property
Capita Property and Infrastructure Ltd.

A3 Transport schemes\Inverness Rugby Club\Report\Appendices\Appendix A\HR7141-PL02 general arrangement - bound sheets for FS 2.dwg - (Plotted 26 March 2015 by Faye Styles)

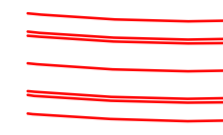

COPYRIGHT, DESIGNS and PATENTS ACT 1988:
 This drawing may not be reproduced, copied or used in any way without the written permission of the Director of Development & Infrastructure.
 © THE HIGHLAND COUNCIL

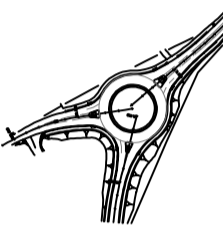
Notes
 Reproduced from the Ordnance Survey mapping with the permission of the Controller of Her Majesty's Stationary Office. © Crown Copyright. Unauthorised reproduction infringes Crown copyright and may lead to prosecution or civil proceedings.
 The Highland Council 2014 100023369

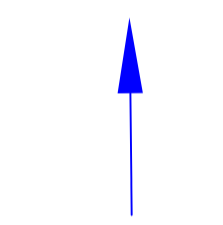
- KEY**
-  PROPOSED WORKS
 -  PROPOSED FENCE
 -  PROPOSED SHARED USE CYCLEWAY / FOOTWAY
 -  PROPOSED FOOTWAY
 -  BUGHT ROAD CLOSURE
 -  CONSENTED IWL SCHEME
 -  A82 - BUGHT DRIVE - BUGHT LANE VEHICLE ACCESS ROUTE
 -  A82 - BUGHT DRIVE - BUGHT AVENUE - BUGHT ROAD VEHICLE ACCESS ROUTE

Revision Details				Drawn	Check	Check	Surf
				By	By	Date	

CAPITA
 The Capita Building
 Kingmoor Business Park
 CARLISLE
 Cumbria
 CA6 4SJ
 Tel: 01228 673000
 Fax: 01228 673111

The Highland Council
Comhairle na Gàidhealtachd
DEVELOPMENT & INFRASTRUCTURE
 PROJECT DESIGN UNIT
 Osprey House
 AInness Point Business Park
 AInness, IV17 0UP
 Phone : 01349 886741
 Fax : 01349 886749
 E-Mail : j.m.smith@highland.gov.uk

Project
RECONFIGURATION OF CANAL PARKS

Title
PLANNING APPLICATION VEHICLE ACCESS ROUTES TO THE DEVELOPMENT SITE (INCLUDING IWL SCHEME)

Scale (at A1) **1:2000**

Drawn	JJA	Date	24/03/2015
Checked	PB	Date	24/03/2015

Project No:	HR7141
Drawing No:	PL44
Rev:	



COPYRIGHT DESIGN AND PATENTS ACT 1987:
 This drawing may not be reproduced, copied or used in any way without the written permission of the Director of Development & Infrastructure.
 © THE HIGHLAND COUNCIL

Notes
 Reproduced from the Ordnance Survey mapping with the permission of the Controller of Her Majesty's Stationary Office © Crown Copyright. Unauthorised reproduction infringes Crown copyright and may lead to prosecution or civil proceedings.
 The Highland Council 2016 100023269

 Existing Car Park

Revision Details	Drawn By	Check By	Check Date	Rev

CAPITA
 The Capita Building
 Mgrison Business Park
 CARLEILE
 Camble
 CA6 4BJ
 Tel: 01276 518800
 Fax: 01276 613111

 **The Highland Council**
Comhairle na Gàidhealtachd
DEVELOPMENT & INFRASTRUCTURE
 PROJECT DESIGN UNIT
 Osprey House
 A'Beinn Pàrtaidh Business Park
 A'Beinn, IV17 0UP
 Phone : 01349 886741
 Fax : 01349 886749
 Email : planning@highland.gov.uk

Project
RECONFIGURATION OF CANAL PARKS

Title
PLANNING APPLICATION FOR EXISTING CAR PARK FOR THE CANAL PARK FACILITY

Scale (if A4)
1:5

Drawn	FS	Date	24/03/2015
Checked	NB	Date	24/03/2015
Project No:	HR57141		
Drawing No:	PL45	Rev	-

All transport schemes/transport strategy, Club Report/Agendas/Reports, AUR57141, CA202 general arrangements - board article, for FS 3.0, by: (Project 28 March 2015) by: Faye Styles





A1 Transport schemes\Inverness Rugby Club\Report\Appendices\Appendix E\HRS7141-PL02 general arrangement - bound xrefs for FS.dwg : (Plotted 26 March 2015 by Faye Styles)

COPYRIGHT, DESIGNS and PATENTS ACT 1988:
 This drawing may not be reproduced, copied or used in any way without the written permission of the Director of Development & Infrastructure.
 © THE HIGHLAND COUNCIL

Notes

Reproduced from the Ordnance Survey mapping with the permission of the Controller of Her Majesty's Stationary Office. © Crown Copyright. Unauthorised reproduction infringes Crown copyright and may lead to prosecution or civil proceedings. The Highland Council 2014 100023369

KEY

-  PROPOSED WORKS
-  PROPOSED FENCE
-  PROPOSED SHARED USE CYCLEWAY / FOOTWAY
-  PROPOSED FOOTWAY
-  EVENT TRAFFIC MANAGEMENT

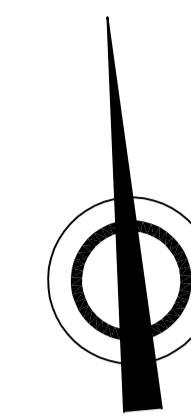

Revision Details	Drawn By	Check By	Check Date	Surf

CAPITA

The Capita Building
 Kingmoor Business Park
 CARLISLE
 Cumbria
 CA6 4SJ

Tel. 01228 673000
 Fax. 01228 673111



DEVELOPMENT & INFRASTRUCTURE

PROJECT DESIGN UNIT
 Osprey House
 Ainess Point Business Park
 Ainess, IV17 0UP

Phone : 01349 886741
 Fax : 01349 886749
 E-Mail : j.m.smith@highland.gov.uk

RECONFIGURATION OF CANAL PARKS

**PLANNING APPLICATION
 EVENT MANAGEMENT
 VEHICULAR ACCESS**

Scale (at A1) **1:500**

Drawn	JJA & CT	Date	24/03/2015
Checked	PB & FS	Date	24/03/2015

Project No: **HRS7141**

Drawing No: **PL46** Rev: **-**

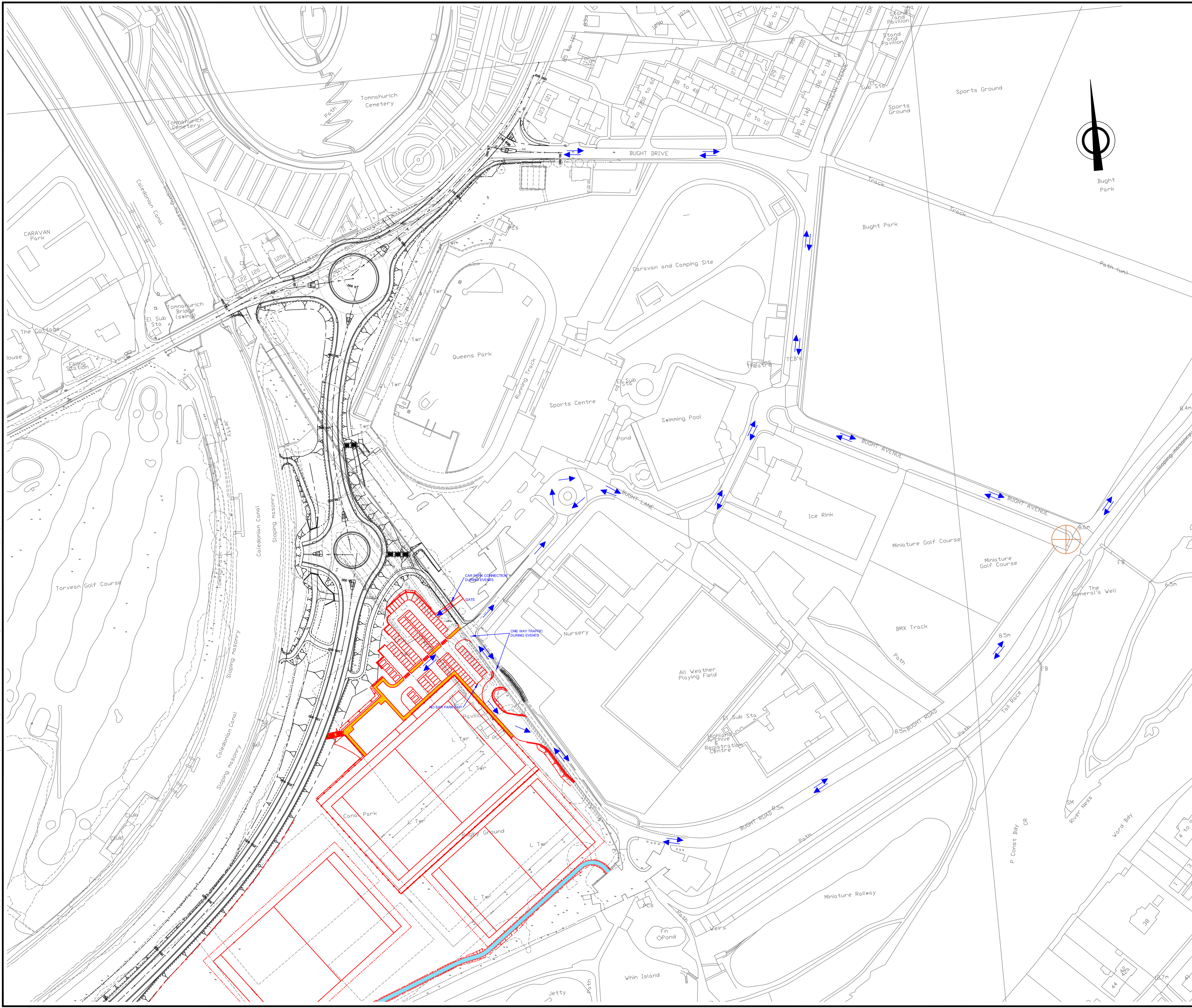

CAR PARK CONNECTION DURING EVENTS
 GATE
 ONE WAY TRAFFIC DURING EVENTS
 NO BAY PARKING