

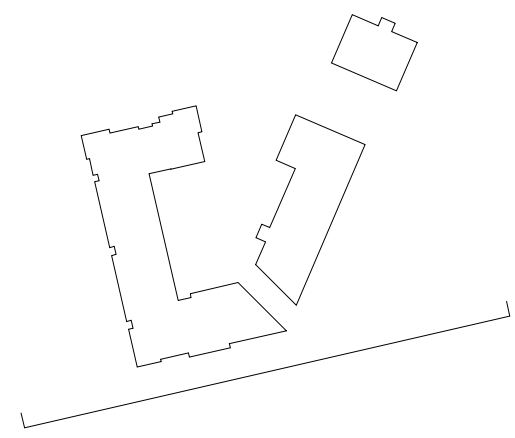

South (Glebe Street) Elevation

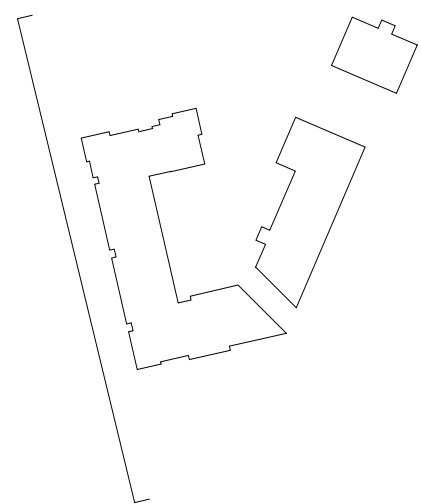

West (Riverfront) Elevation



HALLIDAY FRASER MUNRO
 CHARTERED ARCHITECTS • PLANNING CONSULTANTS
 ABERDEEN • BELFAST • DUNDEE • EDINBURGH • GLASGOW

Tulloch Homes

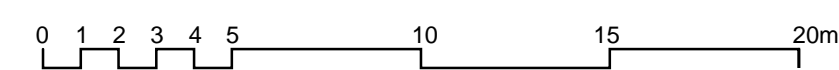

Proposed Residential Development
 Glebe Street, Inverness

Contextual Elevations

Scale: 1:200 @ A1
 Date: November 2015
 Dwg No: A5281/ PL (-)06A

Copyright of this drawing subsists in Halliday Fraser Munro



Section A-A



Section B-B

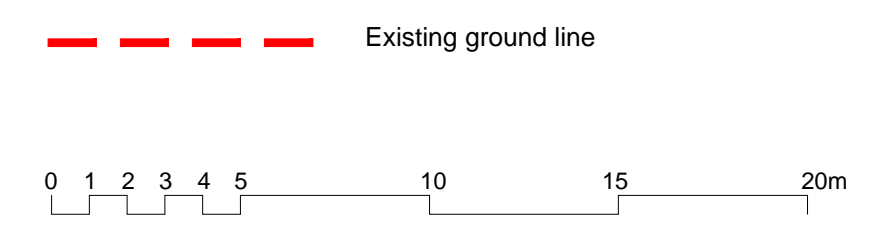

Proposed Residential Development
 Glebe Street, Inverness

Proposed site conditions

Scale: 1:200 @ A1
 Date: November 2015
 Dwg No: A5281/ PL(-)04A

Copyright of this drawing subsists in Halliday Fraser Munro





Vertical massing which steps down to relate to low rise buildings on Douglas Row and Glebe Street



View looking South from Gilbert Street



Gateway building at Friars Bridge



Gateway building at Friars Bridge



Enhancement of river walkway with soft landscaping and feature iron work



Lighting and soft landscaping used to improve the open space adjacent to Friars Bridge





New public open space and public art located on the river walkway

