

HALLIDAY FRASER MUNRO

CHARTERED ARCHITECTS • PLANNING CONSULTANTS

ABERDEEN • BELFAST • DUNDEE • EDINBURGH • GLASGOW

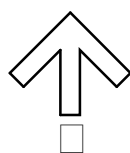

Tulloch Homes

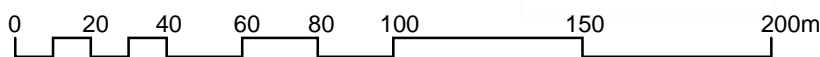

Proposed Residential Development
Glebe Street, Inverness

Location Plan

Scale: 1:1250 @ A3
Date: June 2015
Dwg No: A5281/ PL(--)-01

Copyright of this drawing subsists in Halliday Fraser Munro

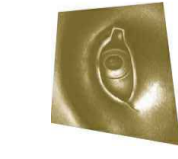

HALLIDAY FRASER MUNRO
CHARTERED ARCHITECTS • PLANNING CONSULTANTS
GLASGOW • BELFAST • DUNDEE • EDINBURGH • GLASGOW

 **Tulloch Homes**

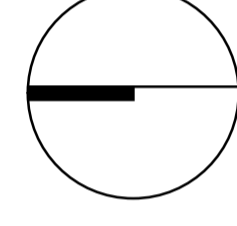

Proposed Residential Development
Glebe Street, Inverness

Proposed Site Plan
Scale: 1:250 @ A1
Date: November 2015
DWG No: AS2817/PL(-)03A
Coverage of the drawing includes Inverness Friars Area



East Elevation



West Elevation



North Elevation



Hidden North Elevation



South Elevation



Hidden South Elevation

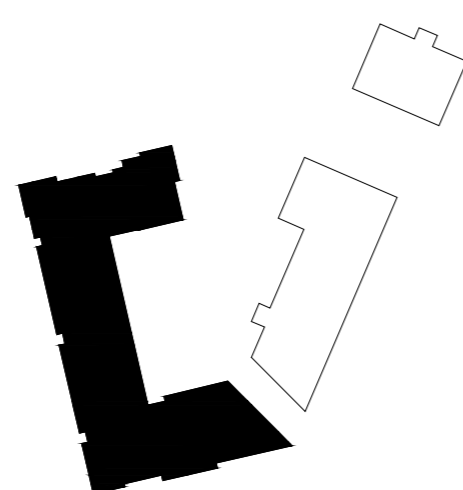

Note: All windows to be inward opening

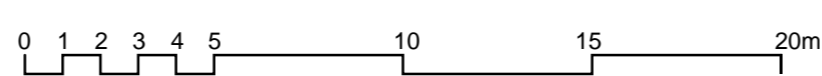



North (Friars Bridge) Elevation

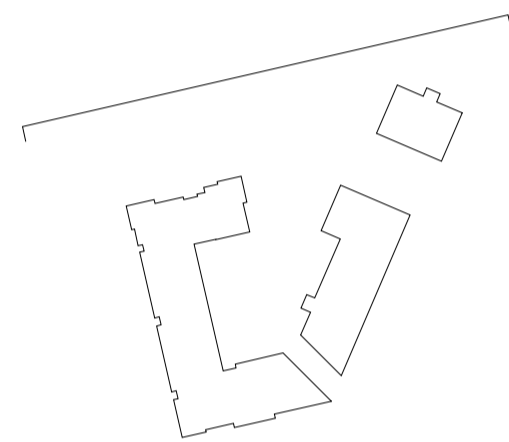

South-East (Glebe Street) Elevation

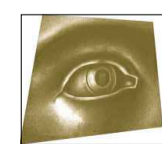
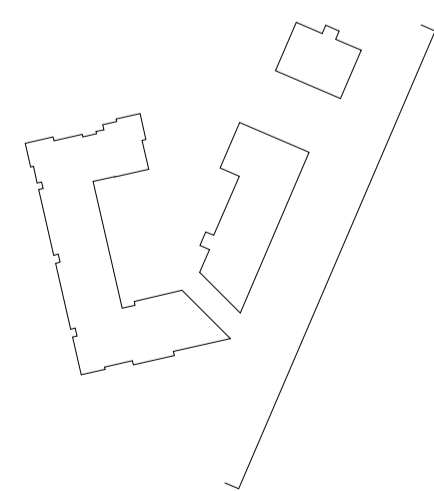

HALLIDAY FRASER MUNRO
 CHARTERED ARCHITECTS • PLANNING CONSULTANTS
 ABERDEEN • BELFAST • DUNDEE • EDINBURGH • GLASGOW

Tulloch Homes

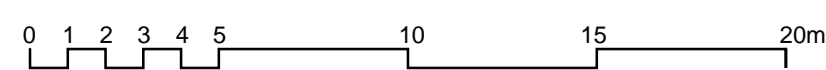

Proposed Residential Development
 Glebe Street, Inverness

Contextual Elevations

Scale: 1:200 @ A1

Date: November 2015

Dwg No: A5281/ PL (-)J05A

Copyright of this drawing subsists in Halliday Fraser Munro



North Elevation



East Elevation



South Elevation

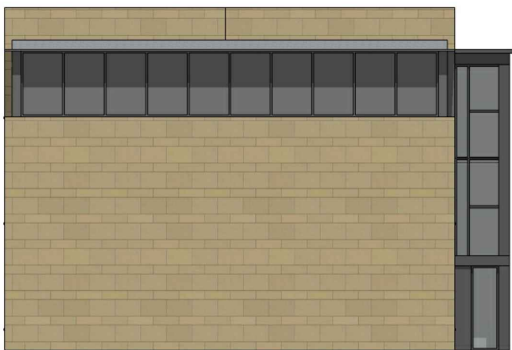

West Elevation

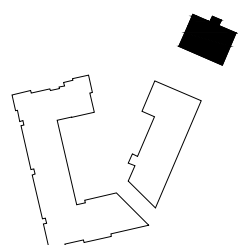

Note: All windows to be inward opening

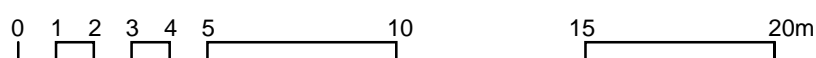



North Elevation



East Elevation



South Elevation



West Elevation

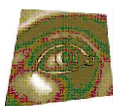

HALLIDAY FRASER MUNRO

CHARTERED ARCHITECTS • PLANNING CONSULTANTS

ABERDEEN • BELFAST • DUNDEE • EDINBURGH • GLASGOW

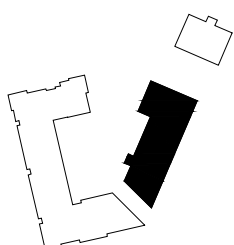

Note: All windows to be inward opening

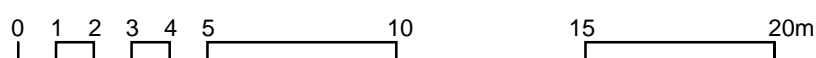

Proposed Residential Development
Glebe Street, Inverness

Block B Elevations

Scale: 1:200 @ A3

Date: November 2015

Dwg No: A5281/ PL(--)-14A

Copyright of this drawing subsists in Halliday Fraser Munro