

horner + maclellan
landscape architects

Client	Reiach + Hall	Date	10-10-2016
Project	Inverness Justice Centre	Status	PLANNING
Drawing Title	Elevations and Sections One	Drawing No	940/JC/ES/01
		Scale	1:50 at A1

No1 Dochfour Business Centre Dochgarroch Inverness IV3 8GY
tel 01463 861 460 fax 01463 861 452 inv@hornermaclellan.co.uk



G

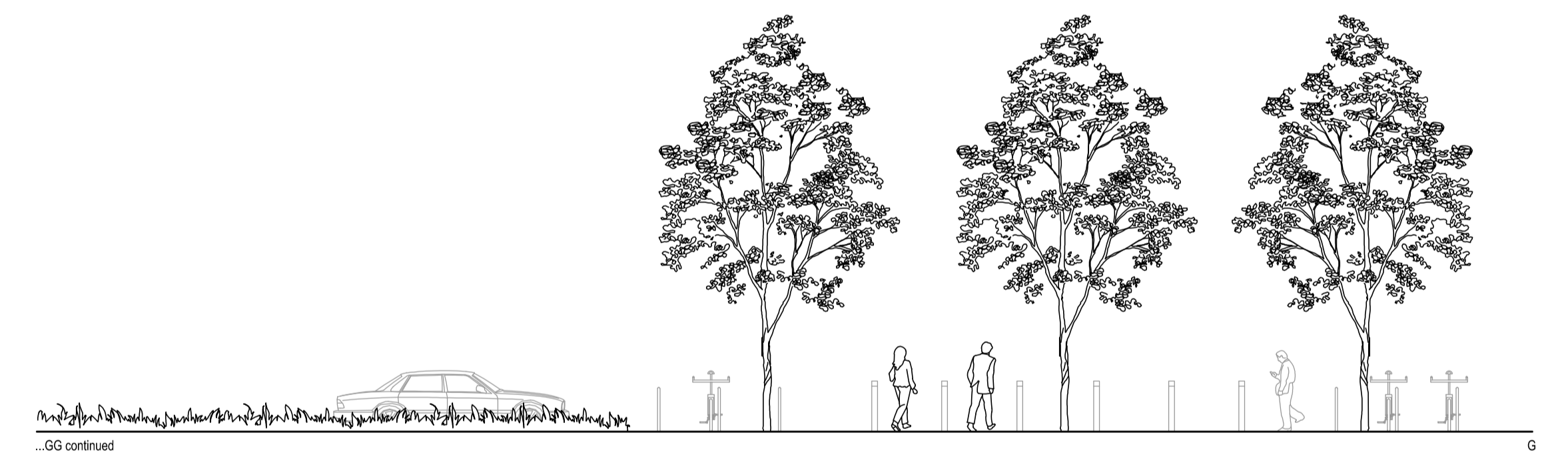

G

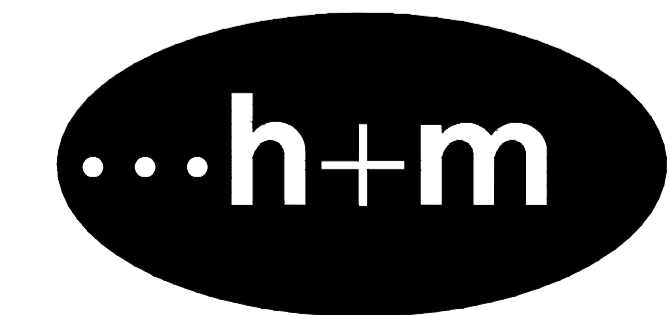

horner + maclellan
landscape architects

Client	Reiach + Hall	Date	10-10-2016
Project	Inverness Justice Centre	Status	PLANNING
Drawing Title	Elevations and Sections Two	Drawing No	940/JC/ES/02
		Scale	1:100 at A1

No1 Dochfour Business Centre Dochgarroch Inverness IV3 8GY
tel 01463 861 460 fax 01463 861 452 inv@hornermaclellan.co.uk

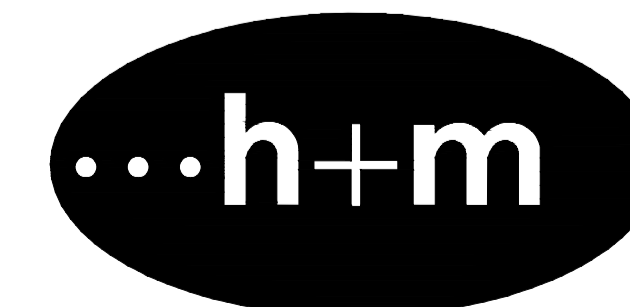
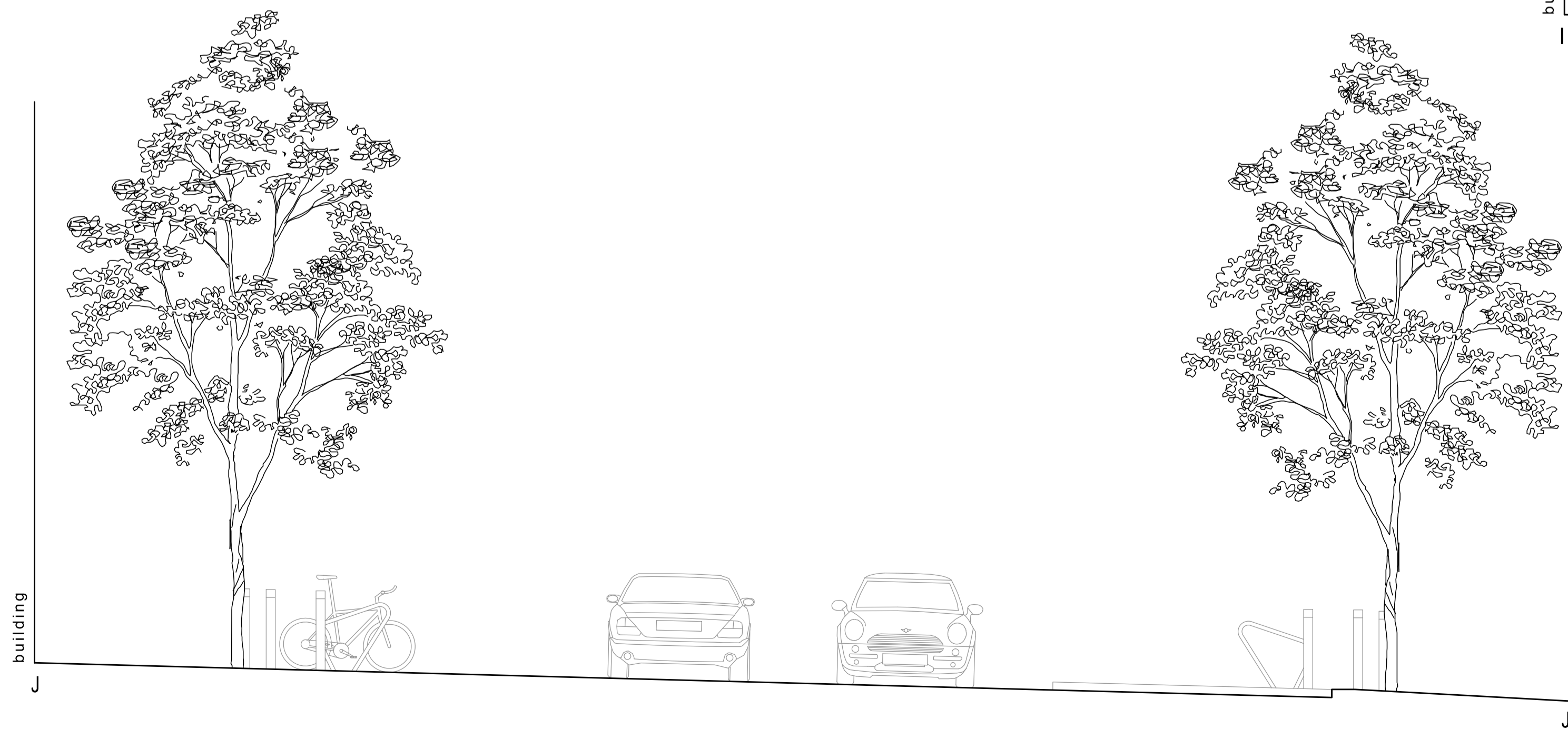
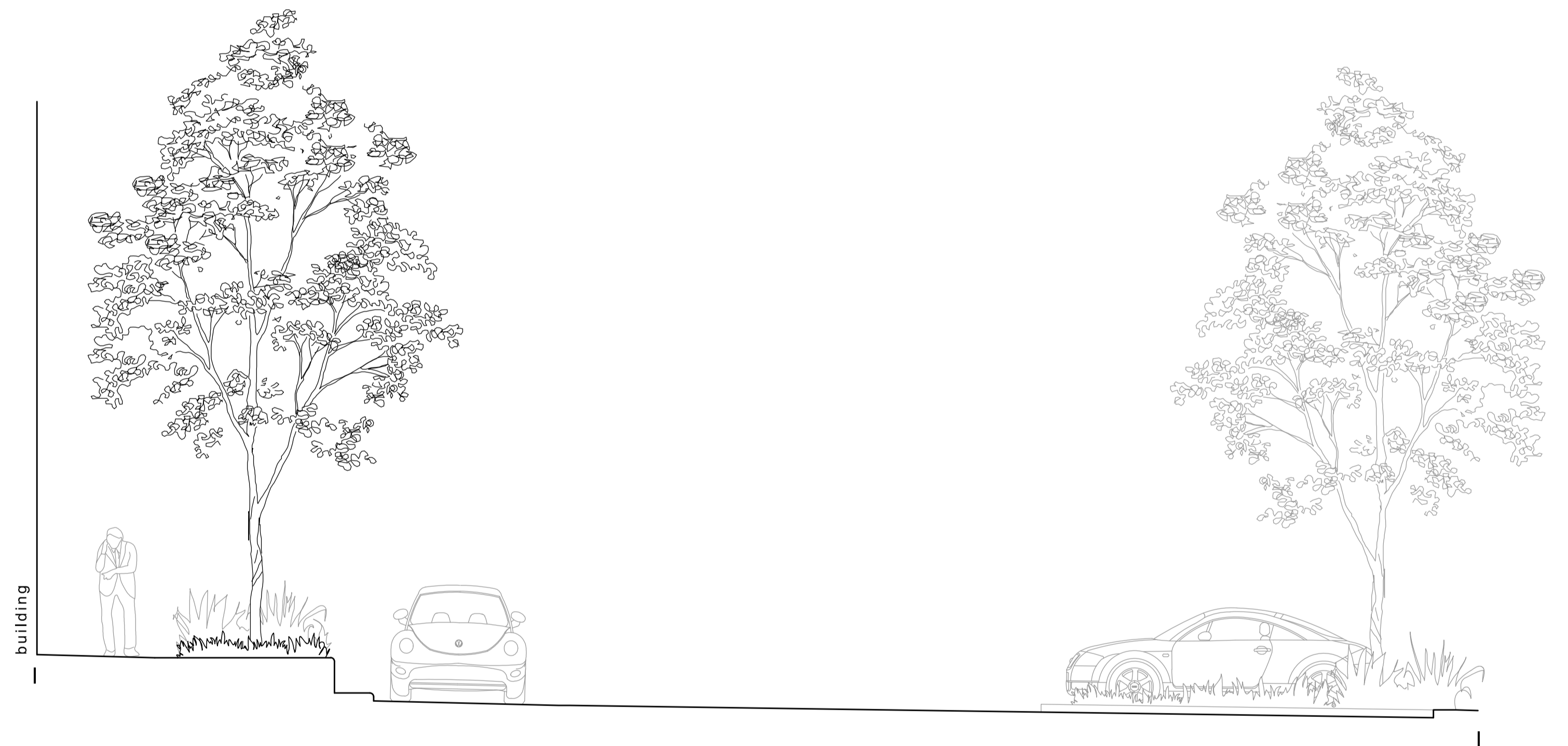
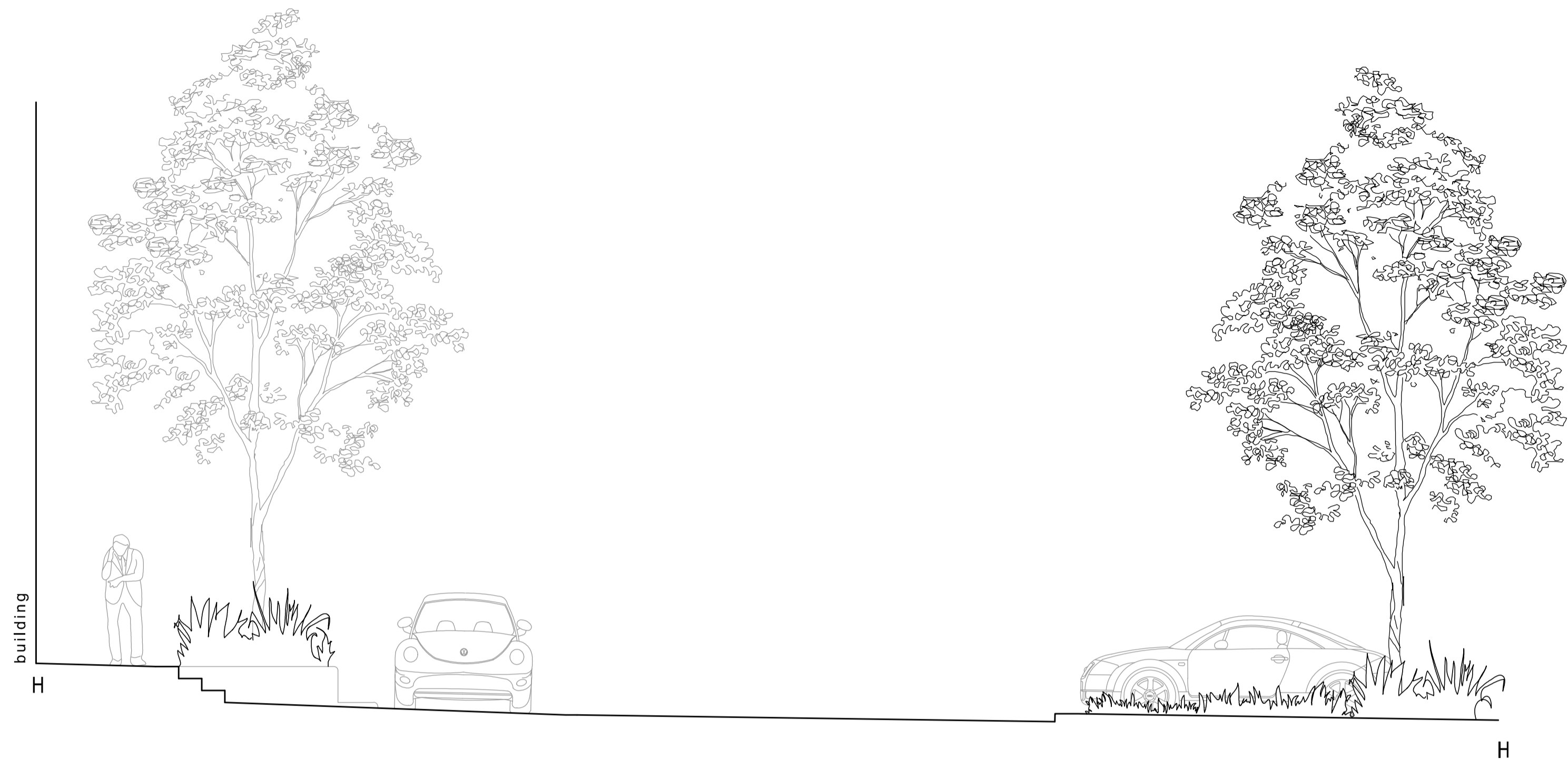

horner + maclellan
landscape architects

Client	Reiach + Hall	Date	10-10-2016
Project	Inverness Justice Centre	Status	PLANNING
Drawing Title	Elevations and Sections Three	Drawing No	940/JC/ES/03
		Scale	1:50 at A1

No1 Dochfour Business Centre Dochgarroch Inverness IV3 8GY
tel 01463 861 460 fax 01463 861 452 inv@hornermaclellan.co.uk

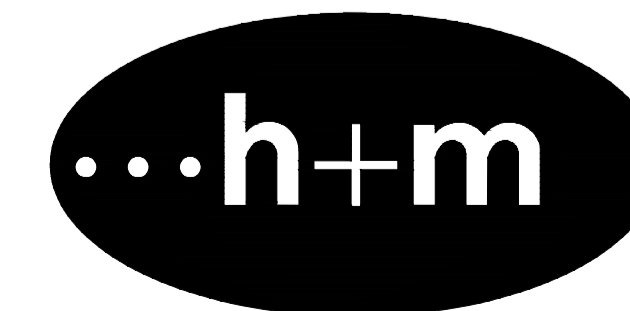
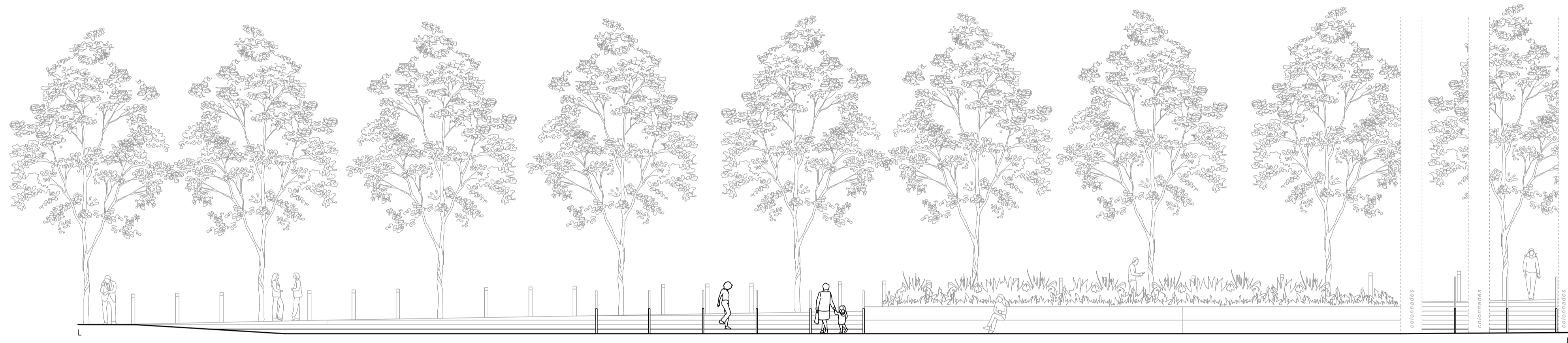
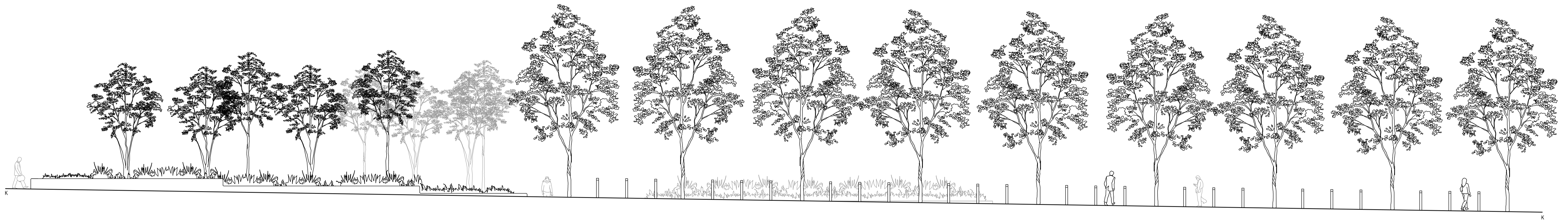

horner + maclellan
landscape architects

Client	Reiach + Hall	Date	10-10-2016
Project	Inverness Justice Centre	Status	PLANNING
Drawing Title	Elevations and Sections Four	Drawing No	940/JC/ES/04
		Scale	1:100 at A1

No1 Dochfour Business Centre Dochgarroch Inverness IV3 8GY
tel 01463 861 460 fax 01463 861 452 inv@hornermaclellan.co.uk

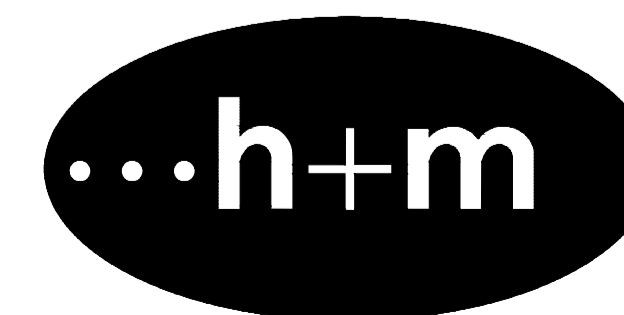
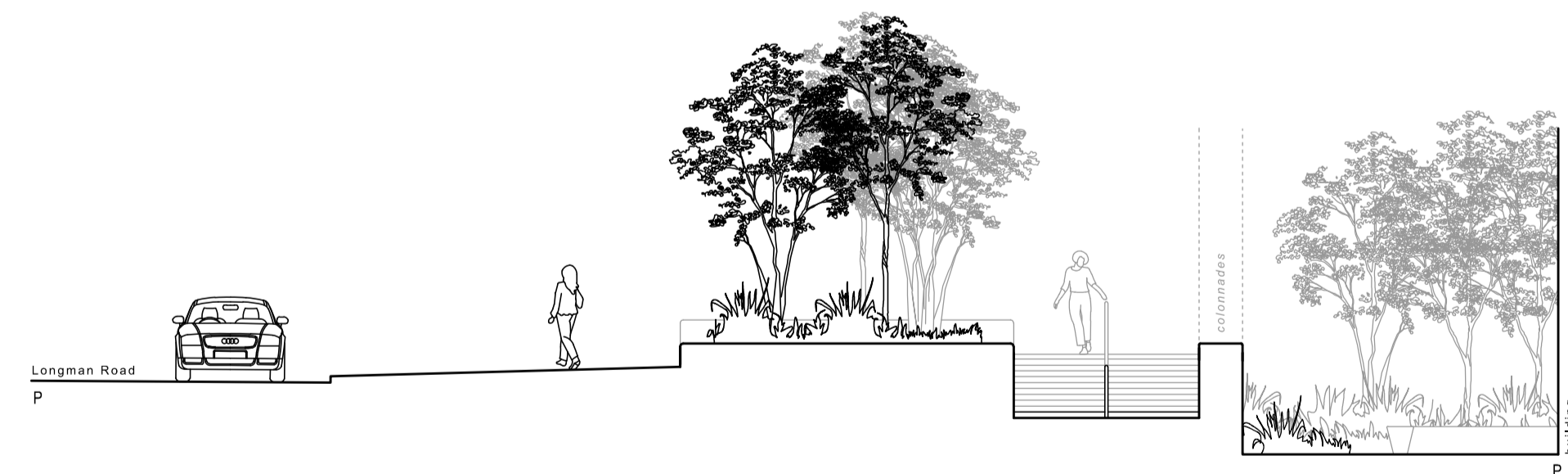
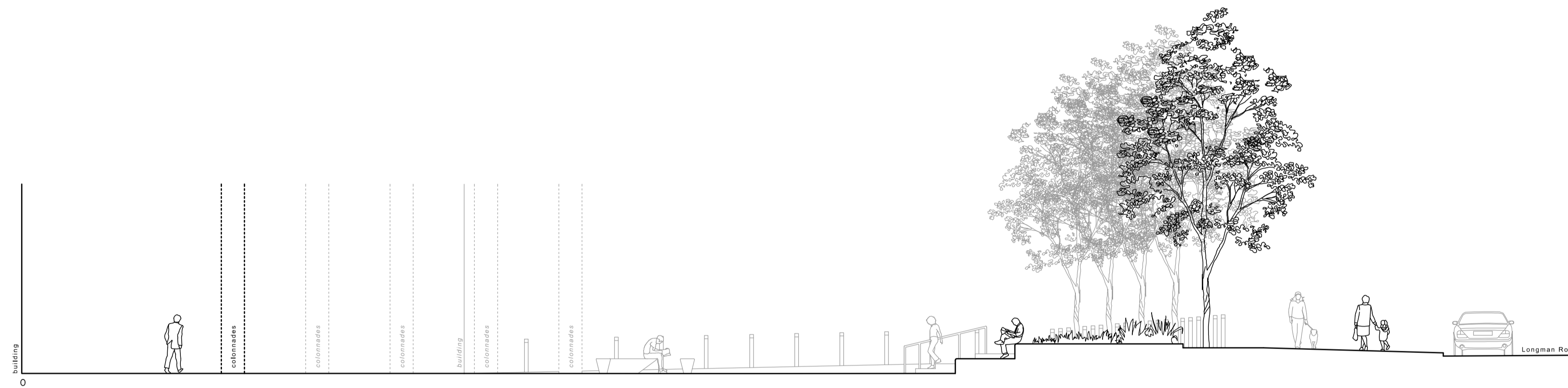

horner + maclellan
landscape architects

Client	Reiach + Hall	Date	10-10-2016
Project	Inverness Justice Centre	Status	PLANNING
Drawing Title	Elevations and Sections Five	Drawing No	940/UC/ES/05
		Scale	1:100 at A1

No1 Dochfour Business Centre Dochgarroch Inverness IV3 8GY
tel 01463 861 460 fax 01463 861 452 inv@hornermaclellan.co.uk

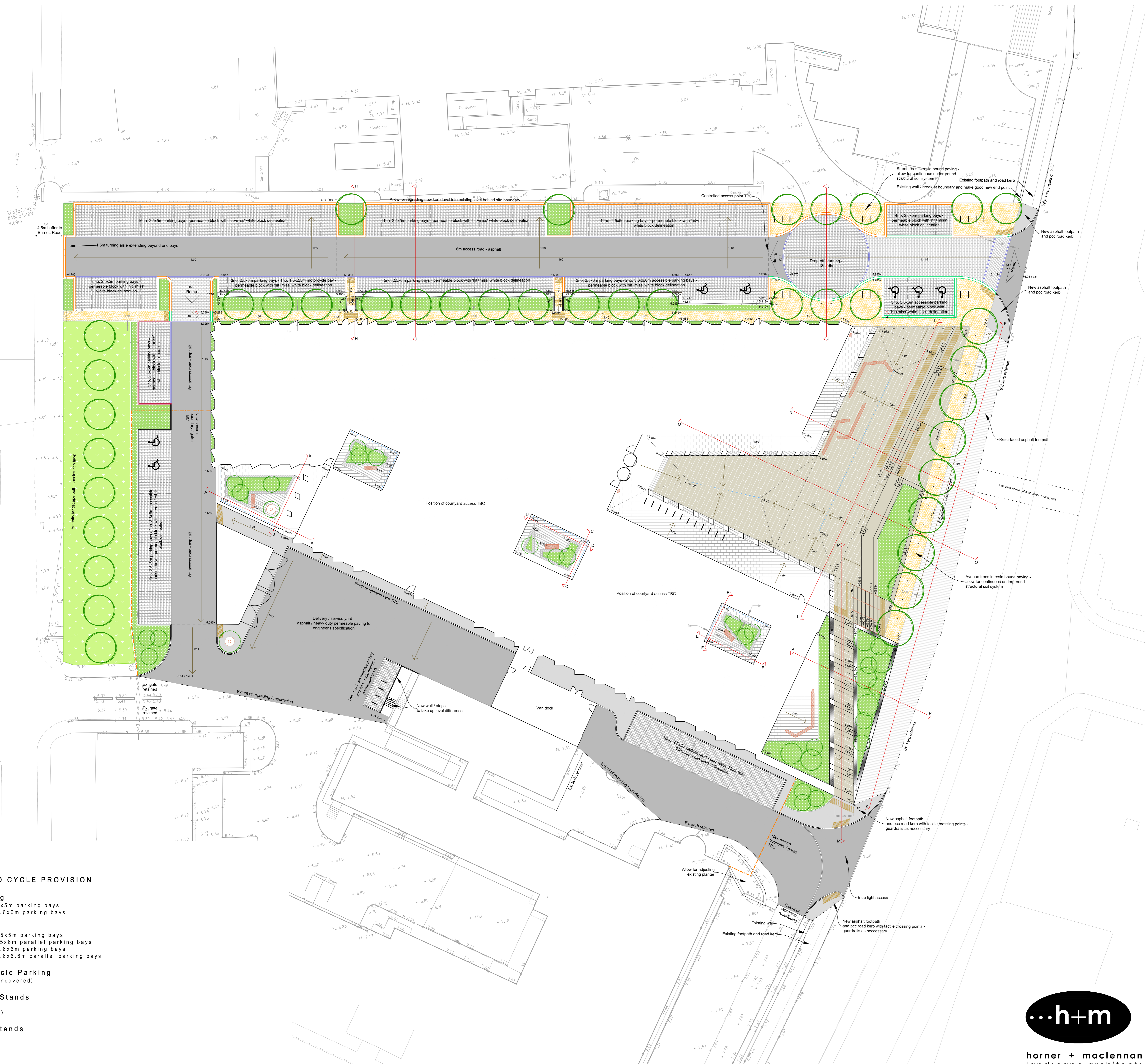
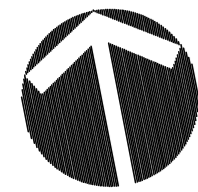

- HARD LANDSCAPE**
- Asphalt road (to engineer's specification)
 - Asphalt footpath (to engineer's specification)
 - Resurfaced asphalt footpath (to engineer's specification)
 - Charcon Andover textured permeable block paving 100x100x80mm, light grey, half stretcher bond with offset joints
 - Charcon Andover textured permeable block paving 100x100x80mm, light grey, herringbone perpendicular to direction of traffic
 - Charcon Andover textured permeable block paving 100x100x80mm, midlight grey, herringbone perpendicular to kerb (top 50% blocks, offsetted legs, and 1m accessibility banding indicated by white blocks - refer to specification)
 - Calithness slate flagstone paving 300mm width, minimum length 600mm maximum unlimited, 50-60mm uncalibrated depth, aligned courses with offset joints, riven
 - Calithness slate paving 100-150mm width, minimum length 600mm maximum unlimited, 50-60mm uncalibrated depth, aligned courses with offset joints, riven
 - Precast concrete paving units 1500x600x75mm, finish to match building (perforated to provide an artistic solution for a SUDS compliant surface or drained by linear side drains - TBC)
 - Precast concrete steps and terrace units steps 150mm riser 600mm tread, seating terrace 450mm riser and 600mm/1800mm tread, finish to match building
 - Precast reinforced concrete retaining wall finish to match building (to architect/engineer's specification)
 - Precast reinforced concrete courtyard planter finish to match building (to architect/engineer's specification)
 - Sureset resin bound paving natural aggregate range, barley beach, 3mm aggregate size - medium texture, finished depth 40mm
 - Charcon Eco Countryside Classic Kerb Wide Top 290x205x14mm, black fleck (appropriate radius, quadrant, and drop kerbs as necessary)
 - Charcon Eco Countryside Classic Kerb Wide Top 200x100x14mm, black fleck, crossing (appropriate radius, quadrant, and drop kerbs as necessary)
 - Charcon Eco Countryside Classic Kerb 145x255x14mm, black fleck (appropriate radius, quadrant, and drop kerbs as necessary)
 - Charcon Eco Countryside Classic Kerb 145x150x14mm, black fleck, crossing (appropriate radius, quadrant, and drop kerbs as necessary)
 - BS PCC Kerb 125x225x914mm, half batter (appropriate radius, quadrant, and drop kerbs as necessary)
 - BS PCC Kerb 125x150x914mm, crossing (appropriate radius, quadrant, and drop kerbs as necessary)
 - BS PCC Pin Kerb 50x150x914mm
 - AluExcel aluminium landscape edging ref AE50RM 50x45mm section, 4mmx2.5m
 - Marshalls Drexus slot drain (to engineer's specification)
 - Stainless steel blister tactile studs 16mm dia (fitted by supplier to relevant DDA/Technical Handbook)
 - Stainless steel corduroy hazard warning strips 28x8mm half round fitting for steps (fitted by supplier to relevant DDA/Technical Handbook)
 - Stainless steel handrails 340mm 1m high, 40-50mm dia, length to suit with 300mm projection beyond top and bottom riser (sized and fitted to relevant DDA/Technical Handbook)
 - Marshalls Spring circle tree grille 1447mm dia, 407mm dia aperture, charcoal grey
 - Omos s71 stainless steel cycle stand 875x950mm, 49mm dia tube (sized as per Technical Handbook)
 - Omos s28 bollard 1000x114mm, brushed 316 grade stainless steel with radially polished cap top section on painted galvanized steel lower section 1.5m ctrs or evenly spaced along distance
 - Omos s16.2 litter bin, with integrated ashtray 1202x503x386mm, 3 and 4mm s355 steel body and hood with RHS chassis, not dipped galvanized throughout
 - Marshalls Clarity concrete bench 2000x650x450mm, slimline concrete legs, white
 - Marshalls Escofel Milenio cast stone seat units acid etched, white (refer to landscape layout and specification for individual and composite units)

- SOFT LANDSCAPE**
- Tree planting
 - Shrub and groundcover planting (finish - lawn grasses except where specified)
 - Species rich grass seeding

- GENERAL**
- Proposed levels
 - Proposed gradients
 - Proposed paving planes
 - Elevation/section lines

Rev. No.	Date	By	Description
Client	Reiach + Hall	Date	10-10-2016
Project	Inverness Justice Centre	Status	PLANNING
Drawing Title	Landscape General Arrangement	Drawing No	940/JC/LGA/01
		Scale	1:200 at A0

PARKING AND CYCLE PROVISION

- Public Parking**
 4no. standard 2.5x5m parking bays
 3no. accessible 3.6x6m parking bays
- Staff Parking**
 68no. standard 2.5x5m parking bays
 11no. standard 2.5x6m parallel parking bays
 2no. accessible 3.6x6m parking bays
 2no. accessible 3.6x6.6m parallel parking bays
- Staff Motorcycle Parking**
 3no. 1.3x2.3m (uncovered)
- Public Cycle Stands**
 12no. (covered)
 18no. (uncovered)
- Staff Cycle Stands**
 4no. (uncovered)

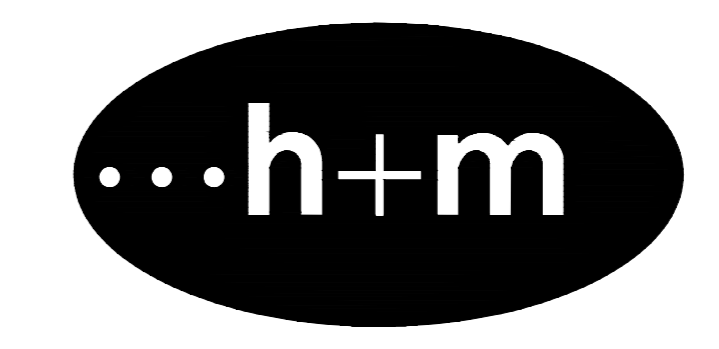

horner + maclellan
landscape architects

No1 Dochfour Business Centre Dochgarroch Inverness IV3 8GY
tel 01463 861 460 fax 01463 861 452 inv@hornermaclellan.co.uk

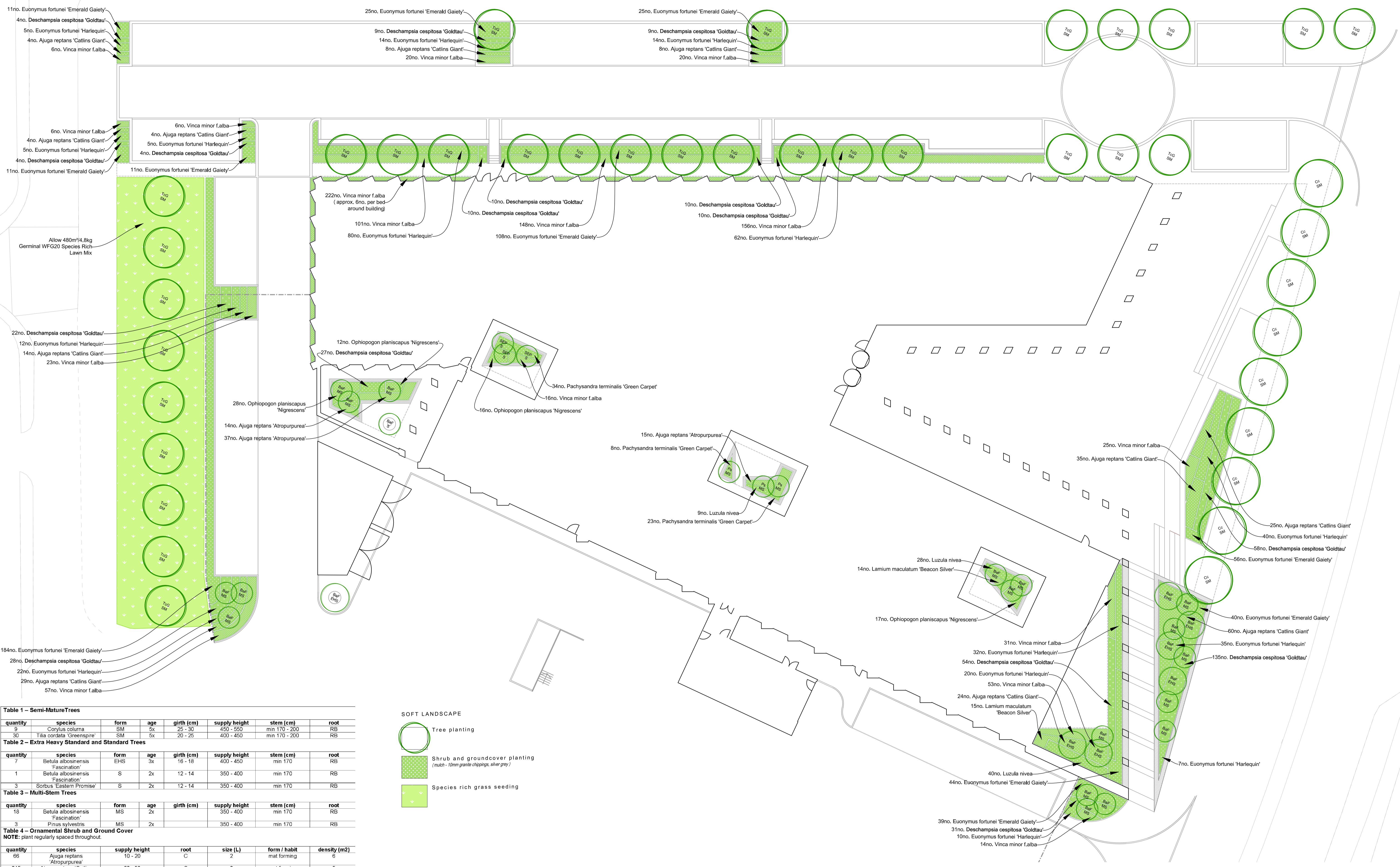

Table 1 - Semi-Mature Trees

quantity	species	form	age	girth (cm)	supply height	stem (cm)	root
9	Corylus colurna	SM	5x	25 - 30	450 - 550	min 170 - 200	RB
30	Tilia cordata 'Greenspire'	SM	5x	20 - 25	400 - 450	min 170 - 200	RB

Table 2 - Extra Heavy Standard and Standard Trees

quantity	species	form	age	girth (cm)	supply height	stem (cm)	root
7	Betula albosinensis 'Fascination'	EHS	3x	16 - 18	400 - 450	min 170	RB
1	Betula albosinensis 'Fascination'	S	2x	12 - 14	350 - 400	min 170	RB
3	Sorbus 'Eastern Promise'	S	2x	12 - 14	350 - 400	min 170	RB

Table 3 - Multi-Stem Trees

quantity	species	form	age	girth (cm)	supply height	stem (cm)	root
18	Betula albosinensis 'Fascination'	MS	2x		350 - 400	min 170	RB
3	Pinus sylvestris	MS	2x		350 - 400	min 170	RB

Table 4 - Ornamental Shrub and Ground Cover
NOTE: plant regularly spaced throughout.

quantity	species	supply height	root	size (L)	form / habit	density (m2)
66	Ajuga reptans 'Atropurpurea'	10 - 20	C	2	mat forming	6
215	Ajuga reptans 'Catlins Giant'	20 - 30	C	2	mat forming	5
425	Deschampsia cespitosa 'Goldtau'	20 - 30	C	2	bushy	5
554	Euonymus fortunei 'Emerald Gaiety'	20 - 30	C	3	bushy	4
363	Euonymus fortunei 'Harlequin'	20 - 30	C	3	bushy	4
29	Lamium maculatum 'Beacon Silver'	10 - 20	C	2	mat forming	6
77	Luzula nivea	20 - 30	C	2	bushy	5
73	Ophiopogon planiscapus 'Nigrescens'	20 - 30	C	2	clump forming	5
65	Pachysandra terminalis 'Green Carpet'	10 - 20	C	2	mat forming	6
904	Vinca minor f. alba	10 - 20	C	2	mat forming	6

SOFT LANDSCAPE

- Tree planting
- Shrub and groundcover planting (mulch - 10mm granite chippings, silver grey)
- Species rich grass seeding

TREE CODES

- Cc SM - Corylus colurna semi-mature
- TcG SM - Tilia cordata 'Greenspire' semi-mature
- BaF EHS - Betula albosinensis 'Fascination' extra heavy standard
- BaF S - Betula albosinensis 'Fascination' standard
- SEP S - Sorbus 'Eastern Promise' standard
- BaF MS - Betula albosinensis 'Fascination' multi-stem
- Ps MS - Pinus sylvestris multi-stem

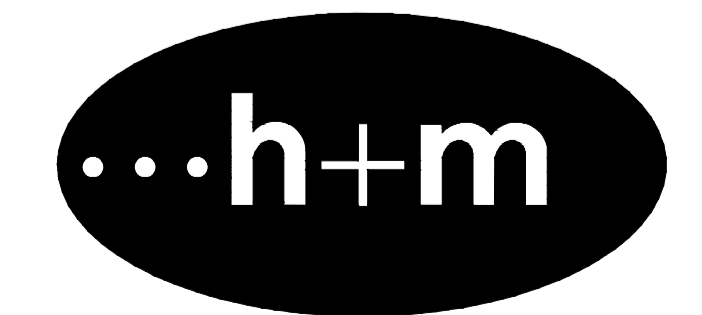

horner + maclellan
landscape architects

Client	Reiach + Hall	Date	10-10-2016
Project	Inverness Justice Centre	Status	PLANNING
Drawing Title	Landscape Planting Plan	Drawing No	940/JC/LPP/01
		Scale	1:200 at A1

No1 Dochfour Business Centre Dochgarroch Inverness IV3 8GY
tel 01463 861 460 fax 01463 861 452 inv@hornermaclellan.co.uk